

①	706039	PCS	②	705018	PCS
		1		120x120x1170	2
③	705369	PCS	④	980114	PCS
		1		Ø4x20	4
⑤	905104	PCS	⑥	905761	PCS
		8		120x120x700	2
	M10				
⑦	905830	PCS	⑧	906569	PCS
		2		1960x520x60	1
	123x123x40				
⑨	980104	PCS	⑩	980123	PCS
		2		Ø7x60	16
	Ø5x90				
⑪	909256	PCS			PCS
		16			
	Ø16/8.4				
		PCS			PCS
		PCS			PCS

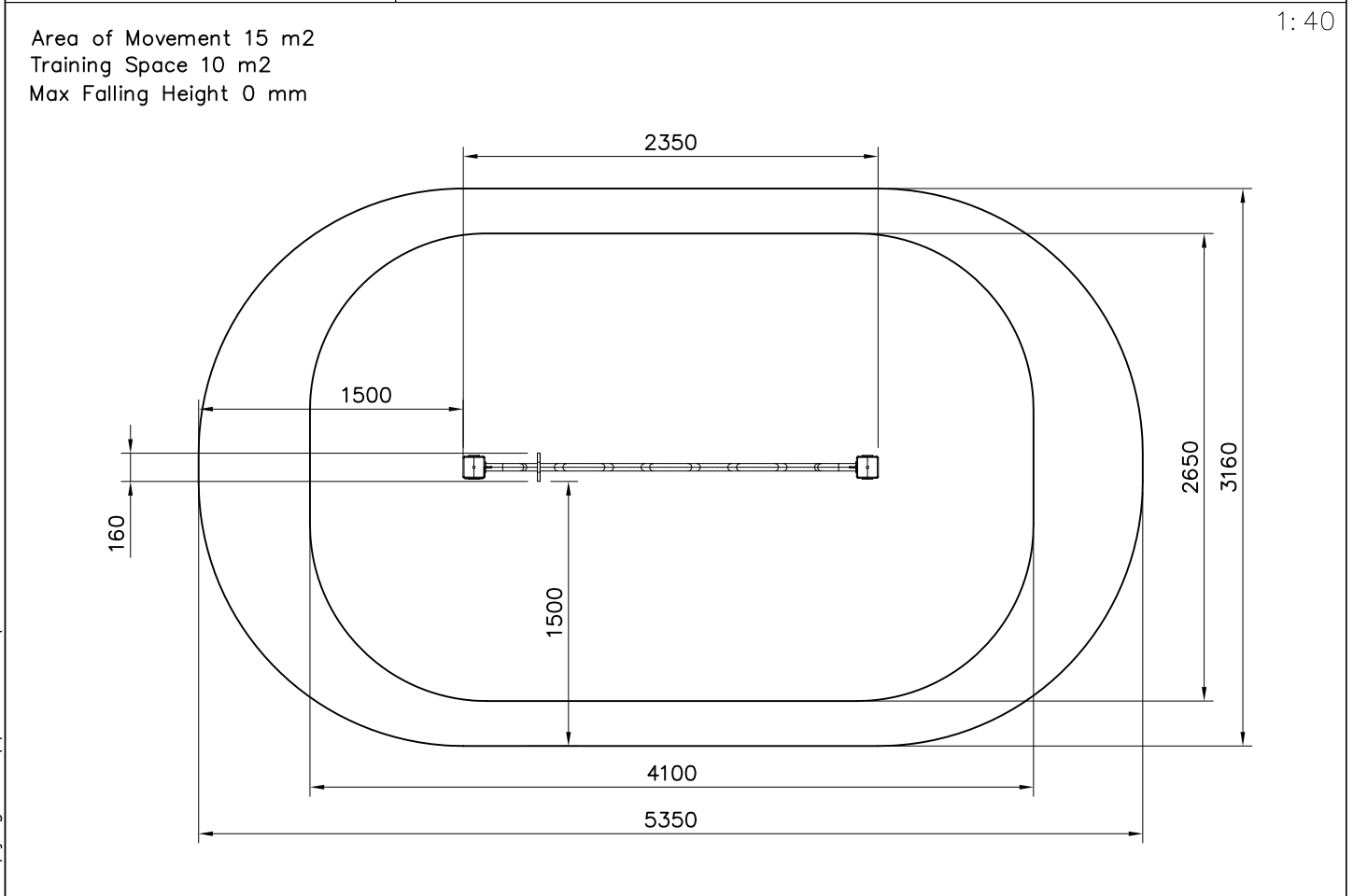

		
<p><b><math>h &lt; 600</math></b></p> <p>Without movement and therefore without Impact Area</p>	<p>Totally hard surfaces.</p> <p>Note. Lappset does <u>not recommend</u> totally hard surfaces at all.</p>	<p>E.g. concrete or asphalt</p> 
<p><b><math>h &lt; 600</math></b></p> <p>With movement e.g. rocking</p>	<p>Materials with very limited impact attenuating properties.</p>	<p>E.g. wood</p> 
<p><b><math>h &lt; 1000</math></b></p>	<p>Materials with significant impact attenuating properties.</p>	<p>fine gravel 0–8 mm</p>  <p>grass</p>  <p>unsorted sand</p> 
<p><b><math>h &lt; 3000</math></b></p>	<p>Loose fill material</p> <p>E.g. sand/gravel 0,25...8 mm D60/D10&lt;3,0 Woodchips 5...30 mm bark 20...80 mm</p>	 <p><math>\underline{S}</math>                      <math>\underline{h}</math></p> <p>30 cm                      &lt; 2,0 m</p> <p>40 cm                      &lt; 3,0 m</p>
	<p>Syntethic granulates</p> <p><math>\underline{S}</math>                      <math>\underline{h}</math></p> <p>40 mm ~&gt; 1,2...1,3 m</p> <p>50 mm ~&gt; 1,5...1,7 m</p> <p>60 mm ~&gt; 1,8...2,0 m</p> <p>70 mm ~&gt; 2,1...2,5 m</p> <p>Note. For accurate values, see manufacturer's instructions.</p>	

REMOVE SAFETY SURFACE/SAND/GRAVEL  
TO CHECK FOUNDATION

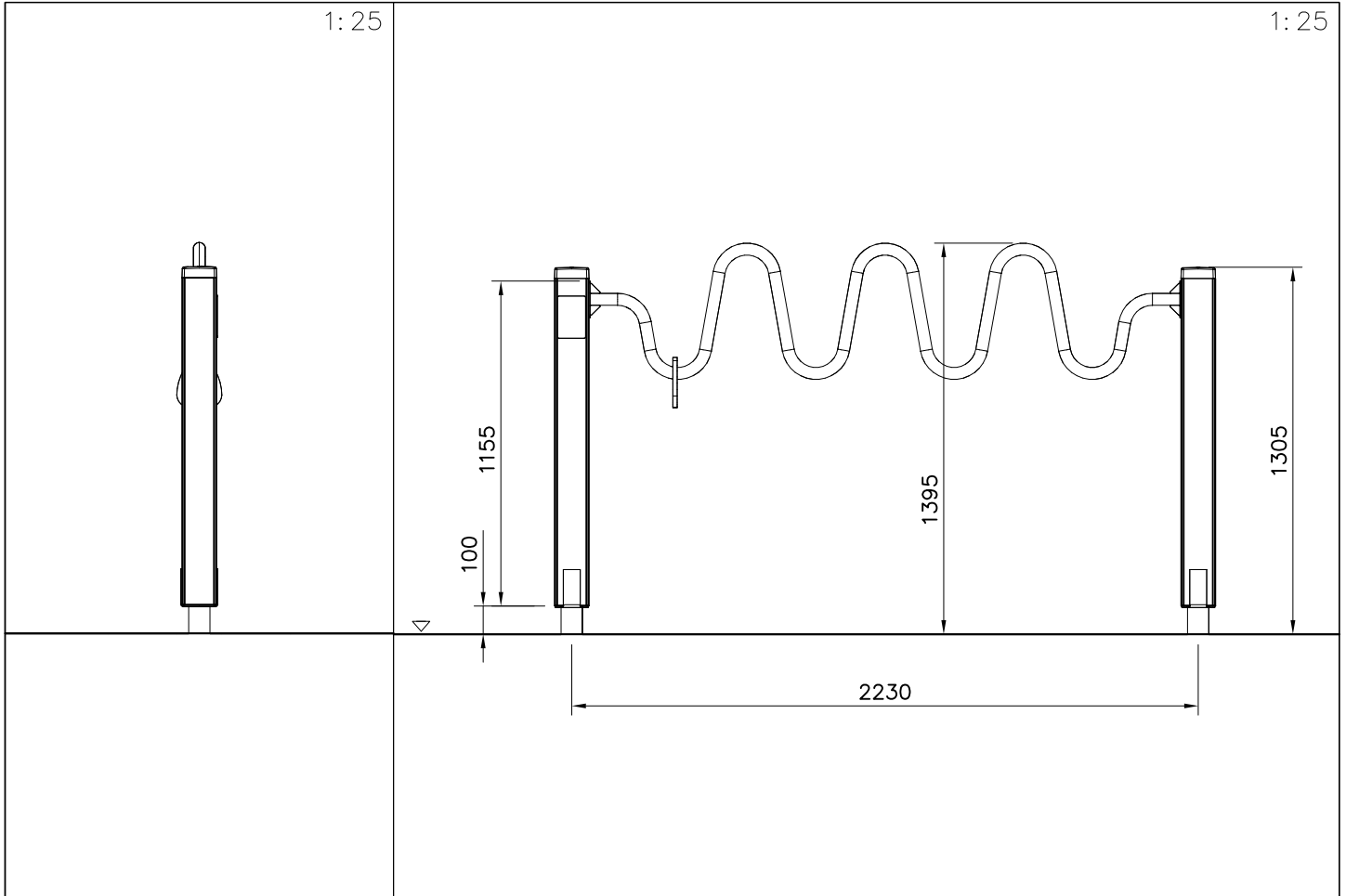

REMOVE SAFETY SURFACE/SAND/GRAVEL  
TO CHECK FOUNDATION



DET 1

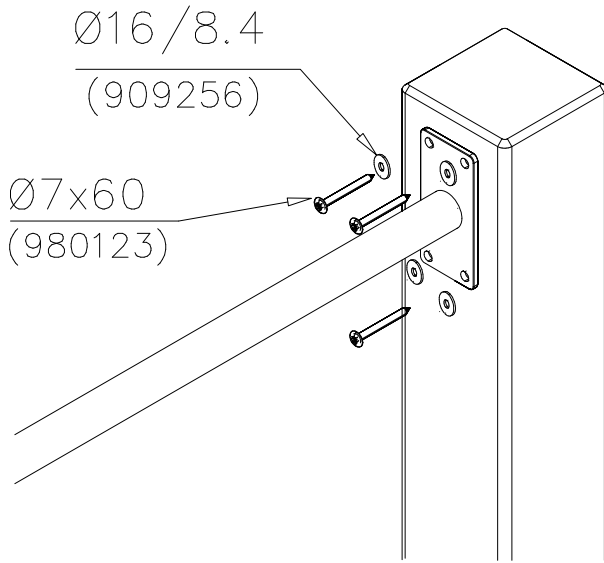

DET 2

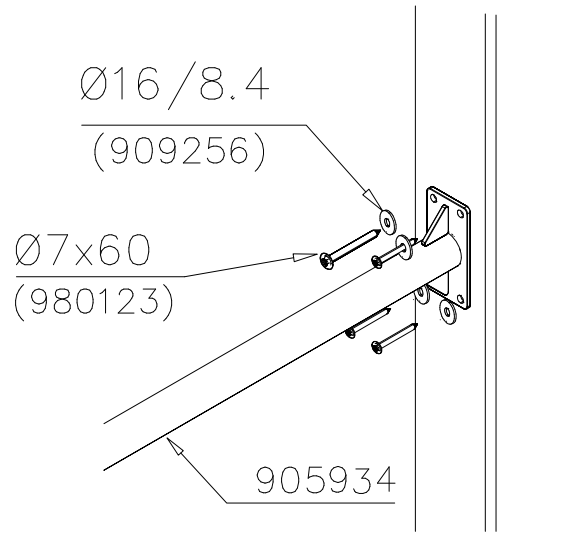

DET 3

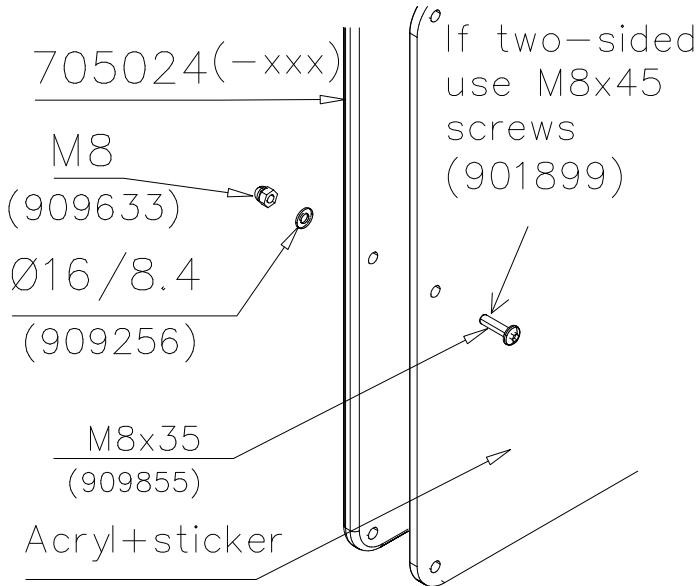

DET 4

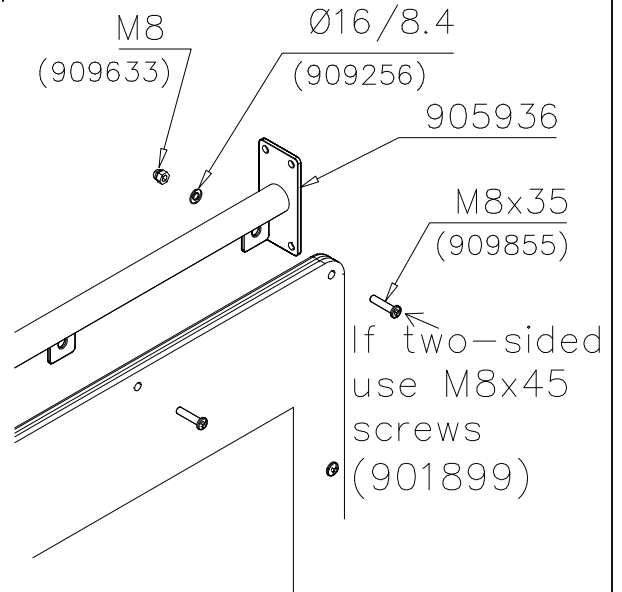

DET 5

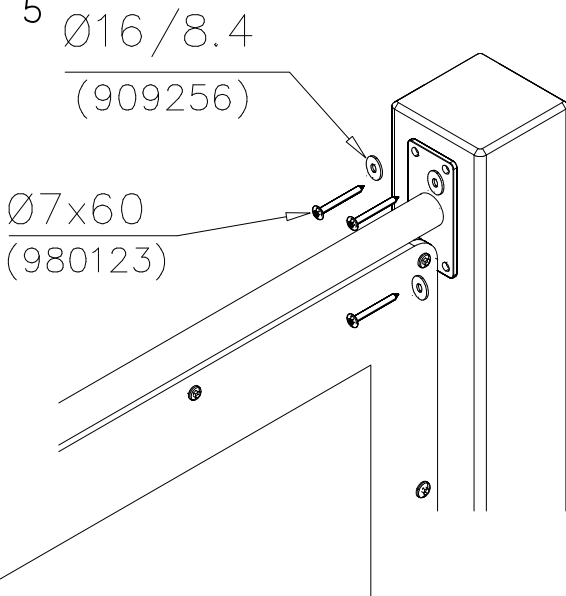

DET 6

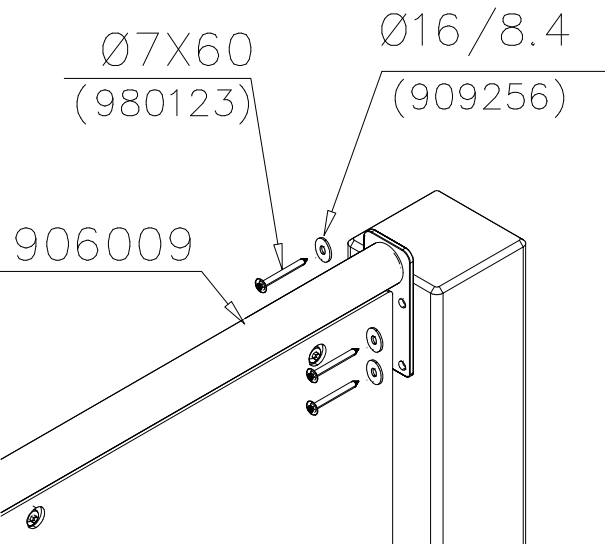

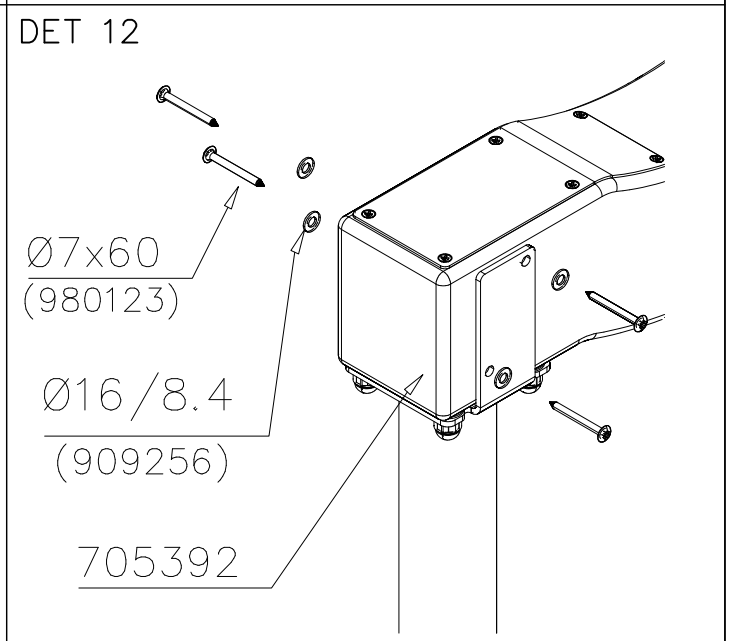
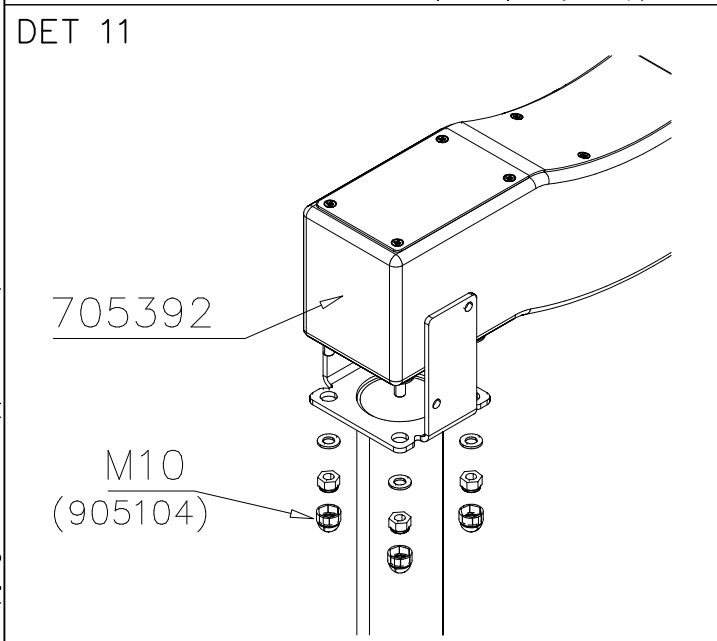
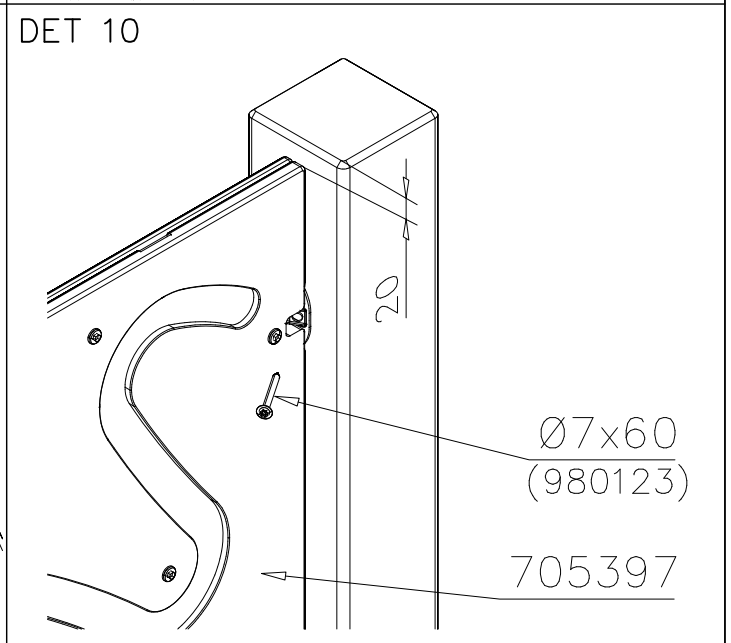
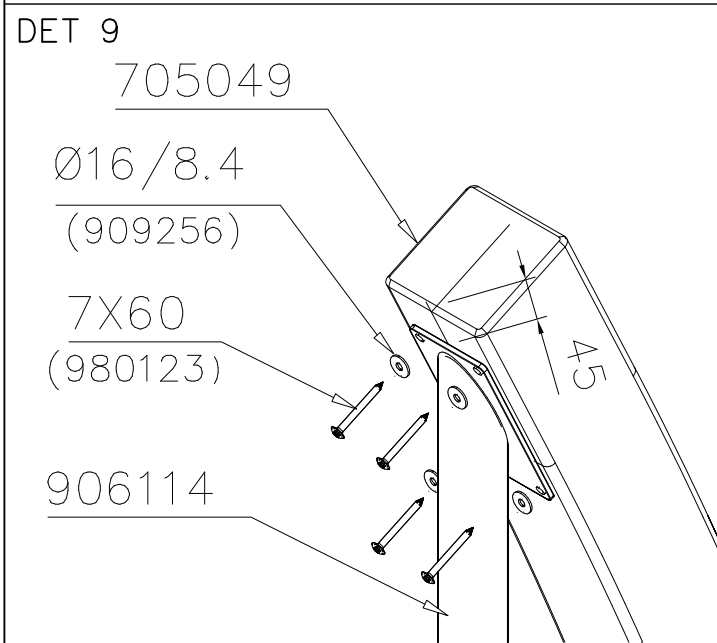
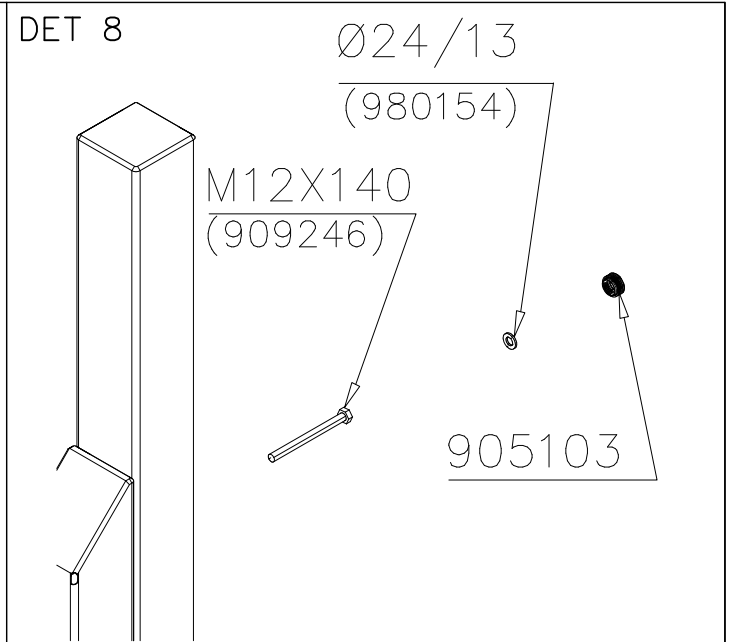
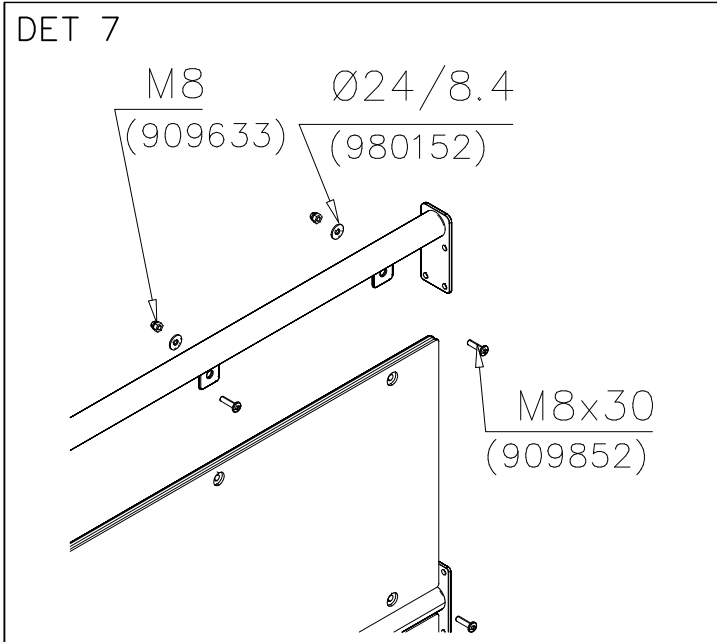

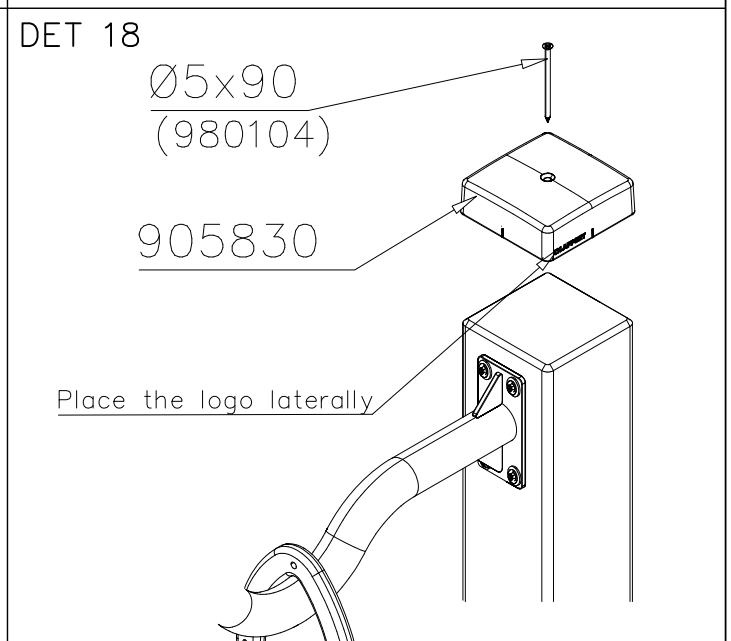
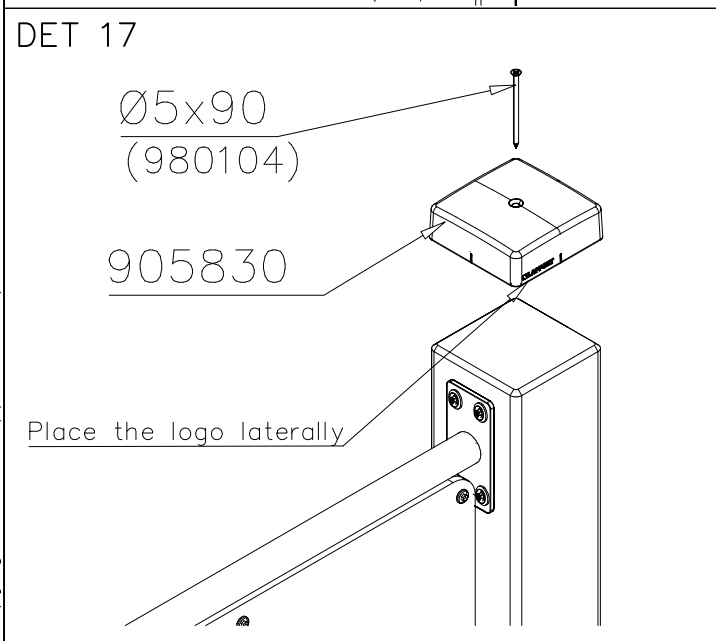
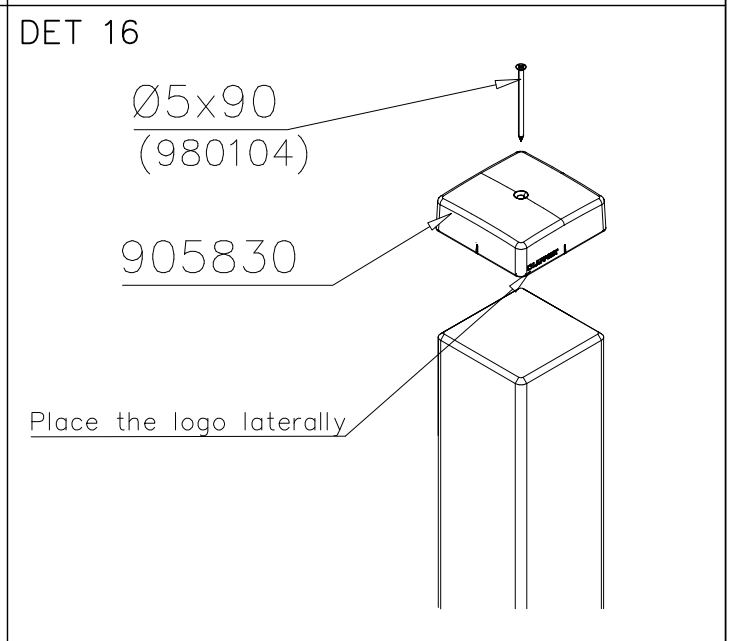
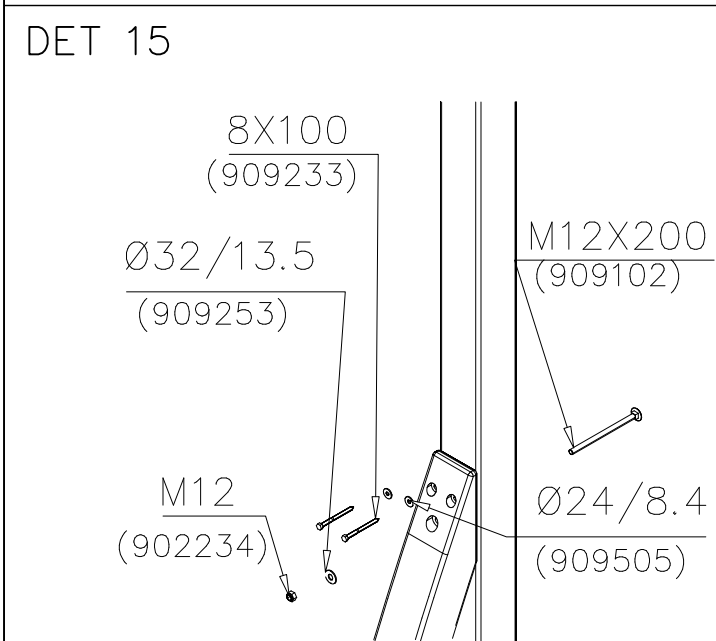
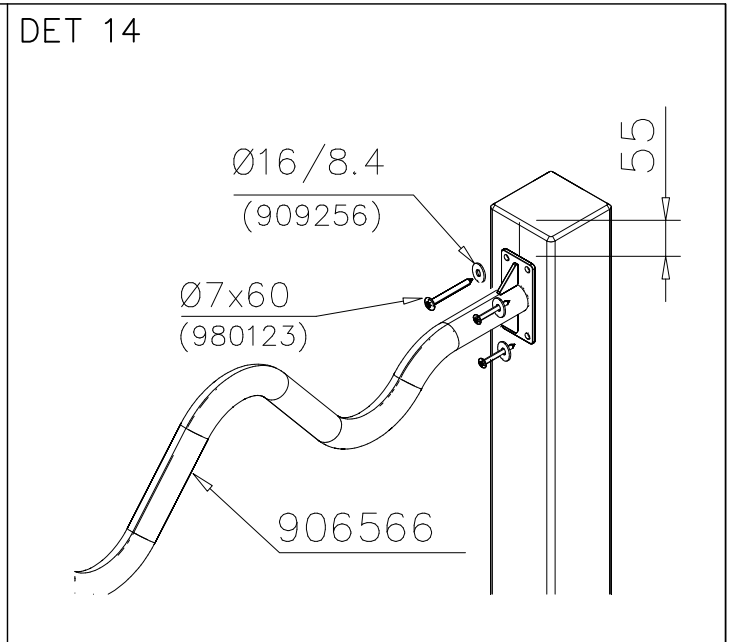
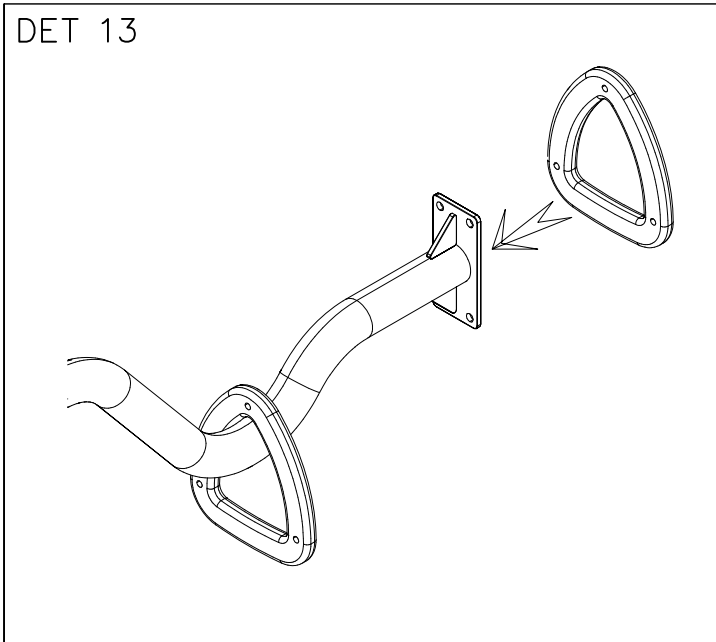

DET 19

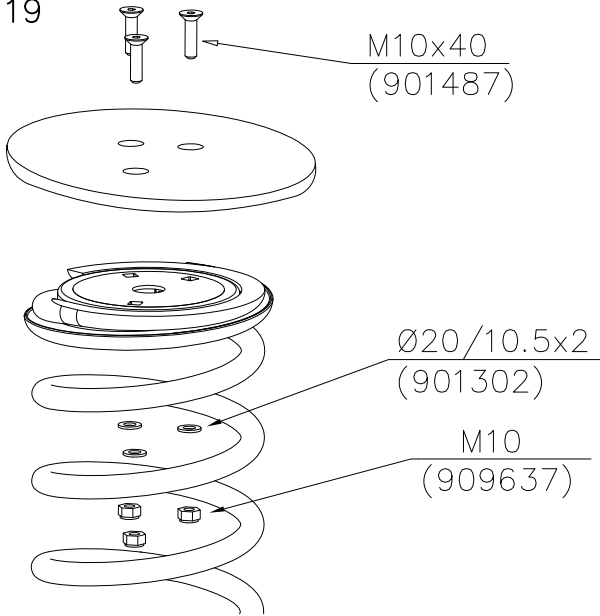

DET 20

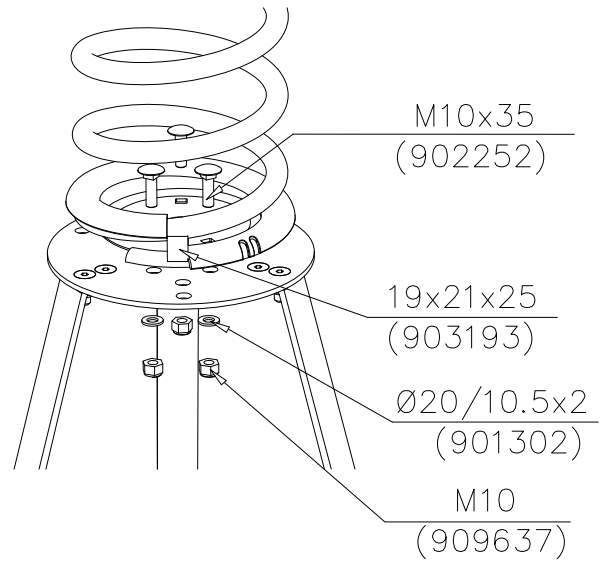

DET 21

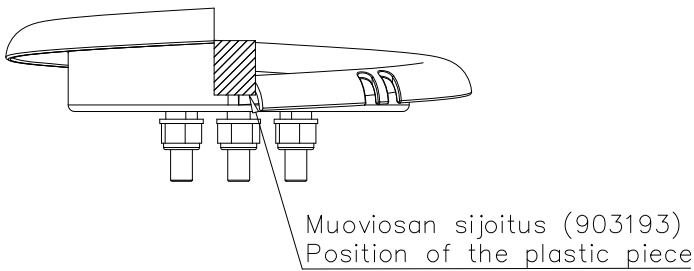

DET 22

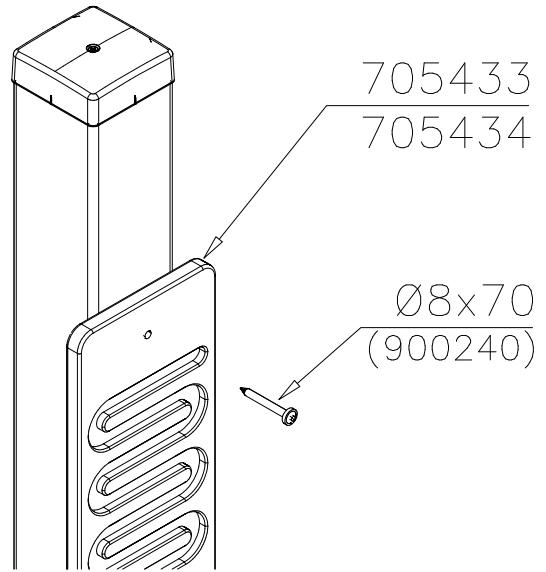

DET 23

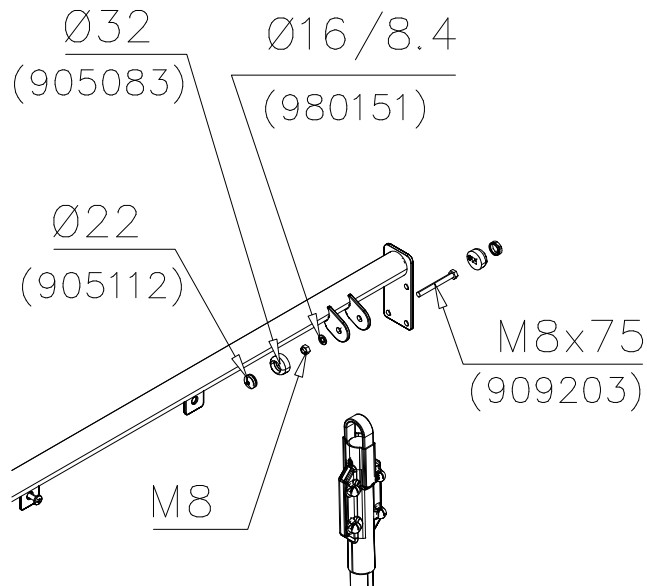

DET 24



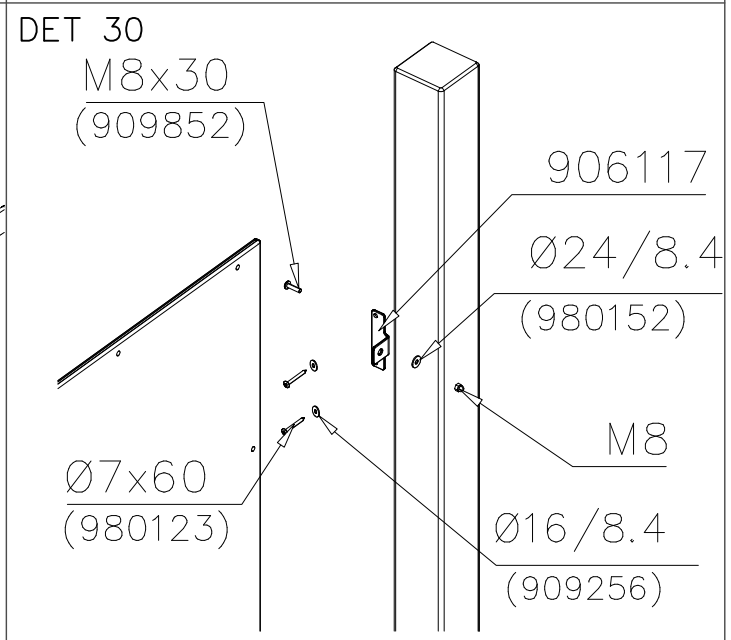
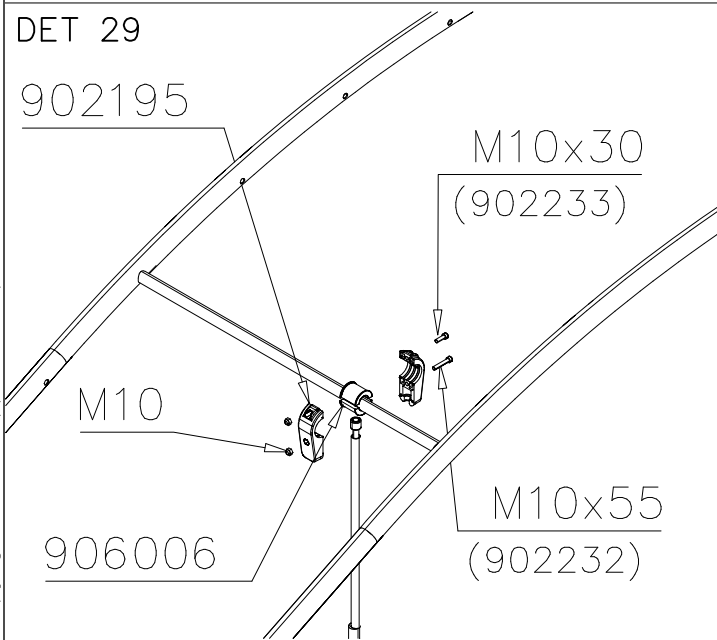
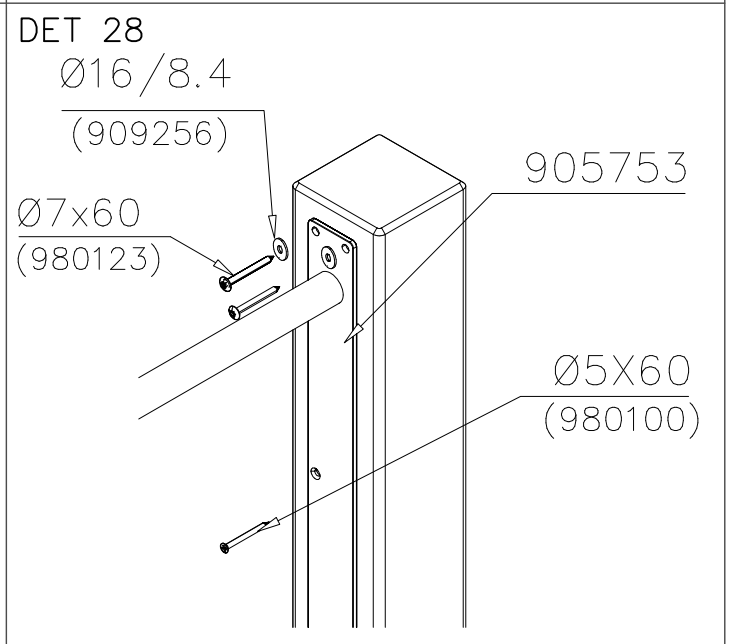
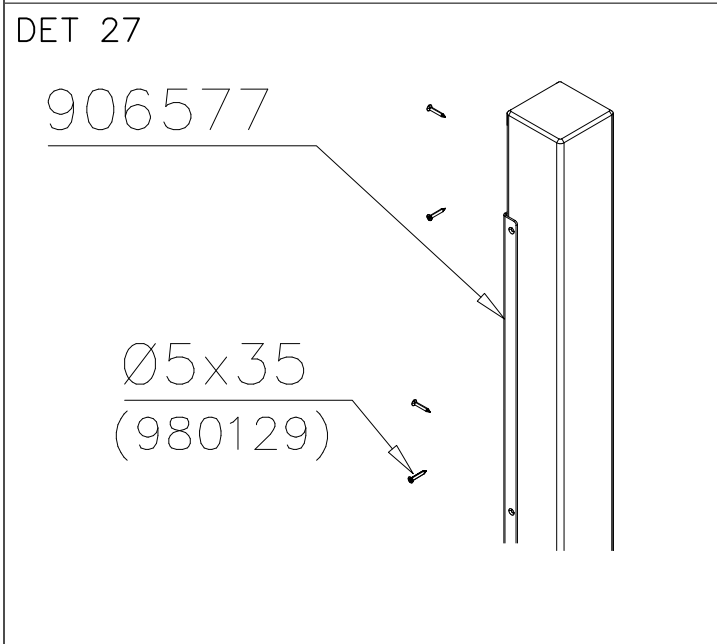
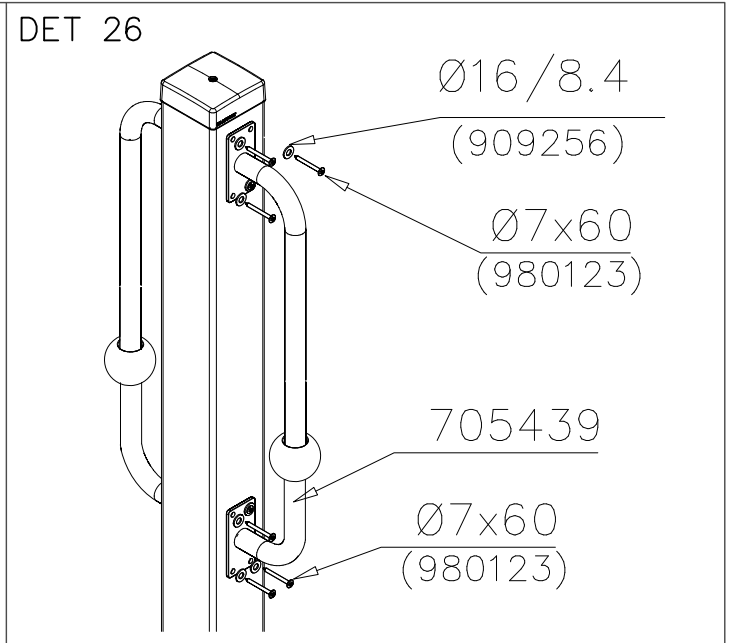
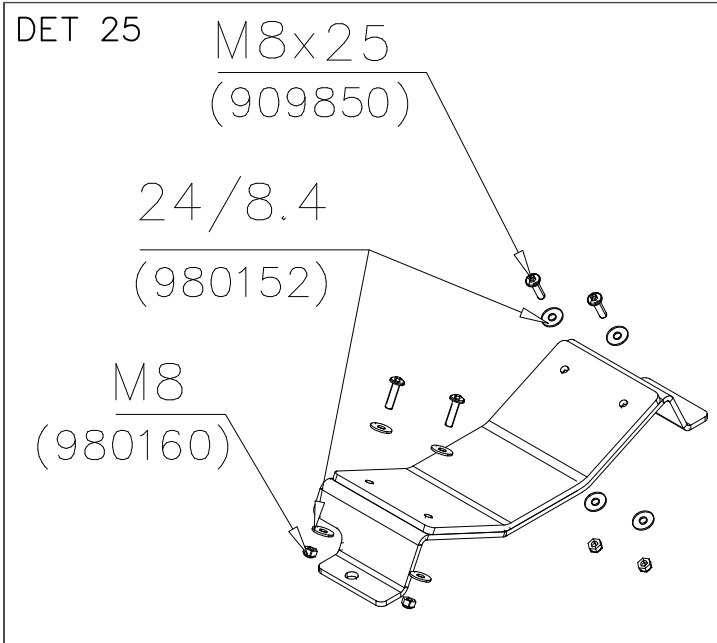

DET 31

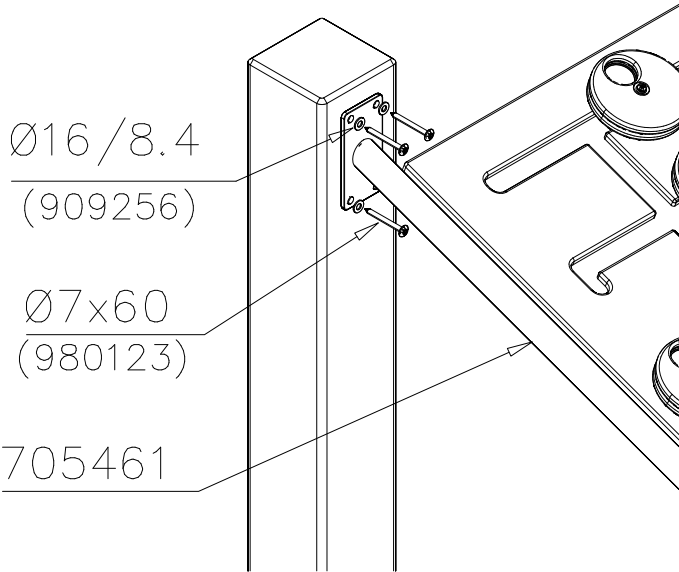

DET 32

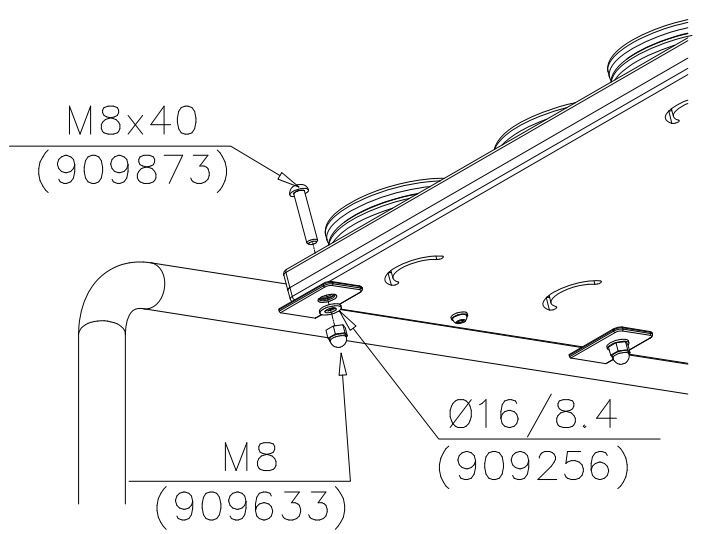

DET 33

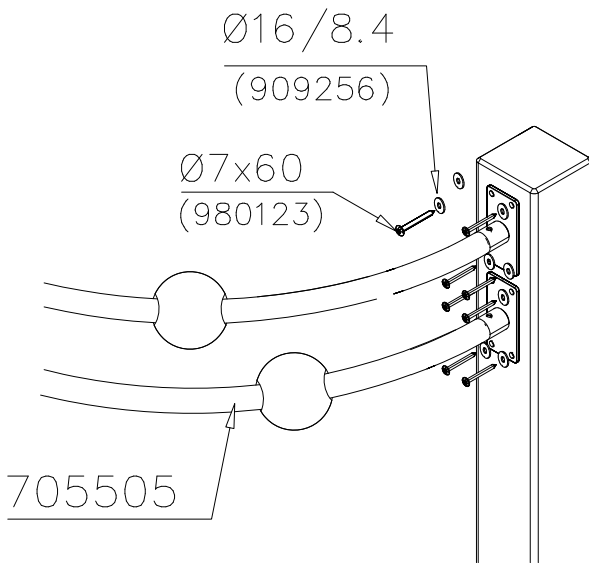

DET 34

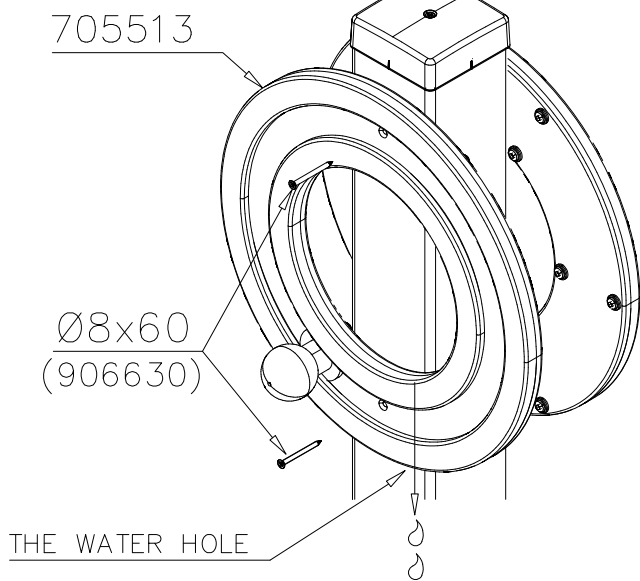

DET 35

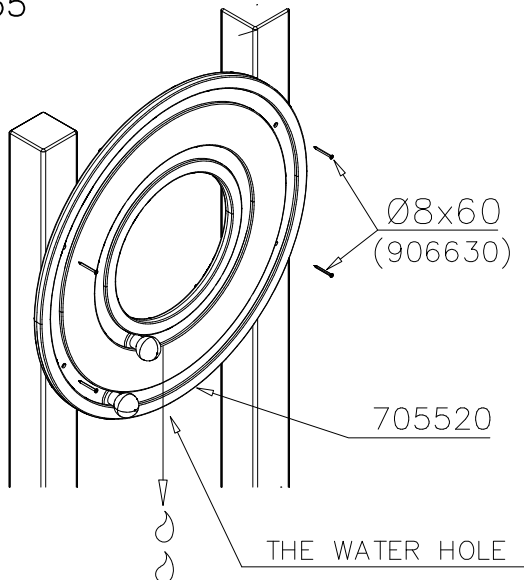

DET 36

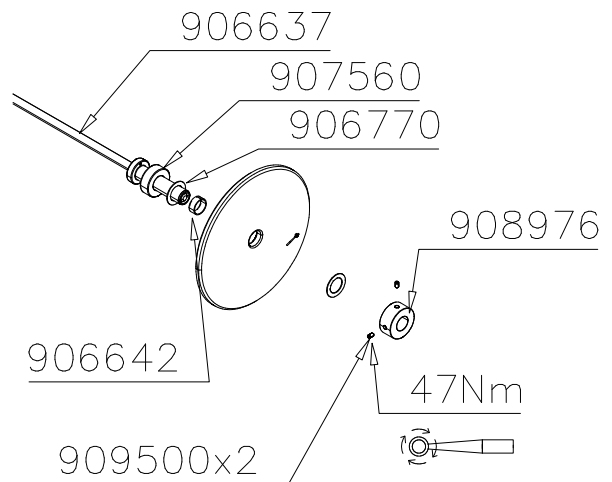

DET 37

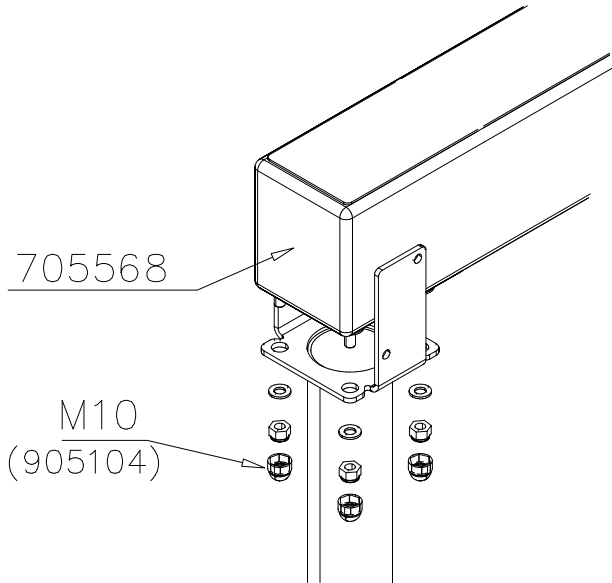

DET 38

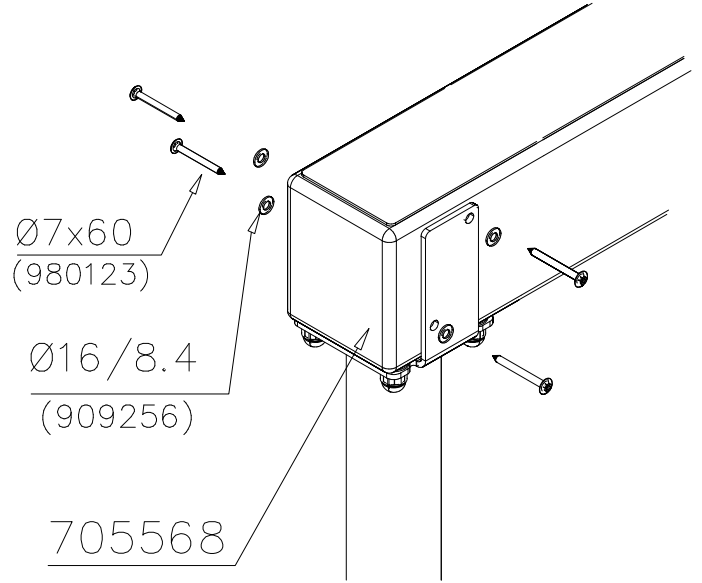

DET 39

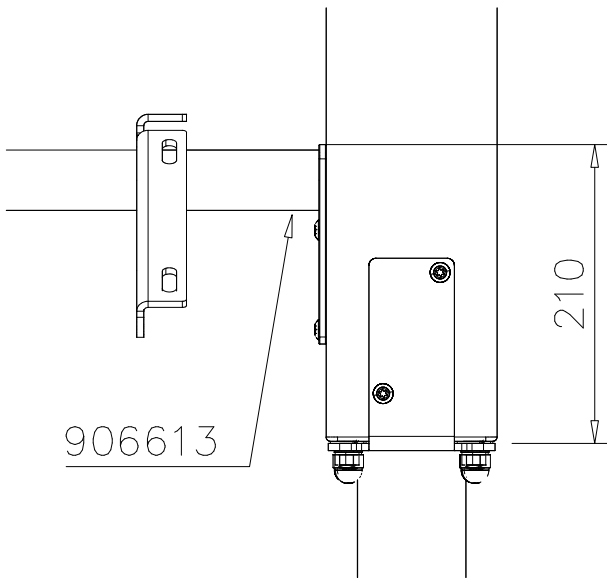

DET 40

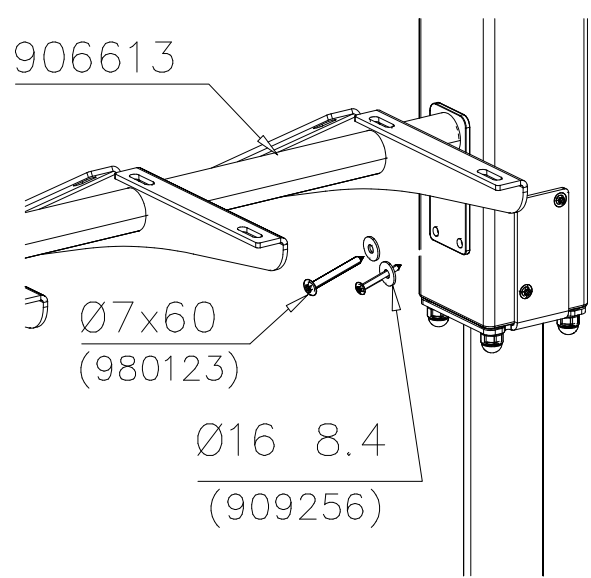

DET 41

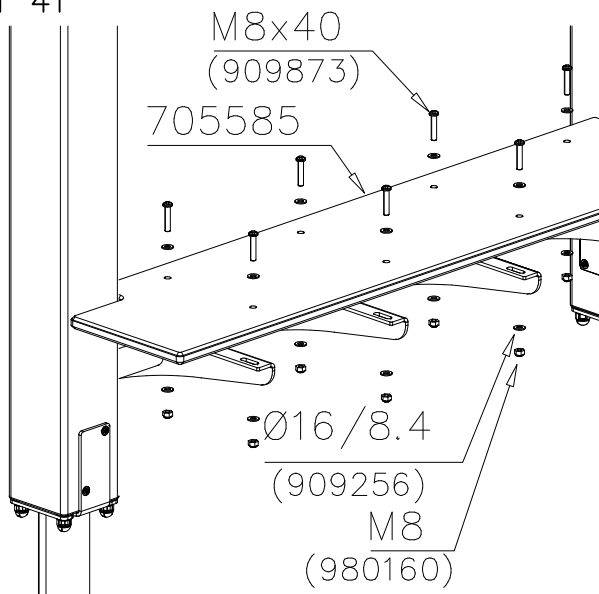

DET 42

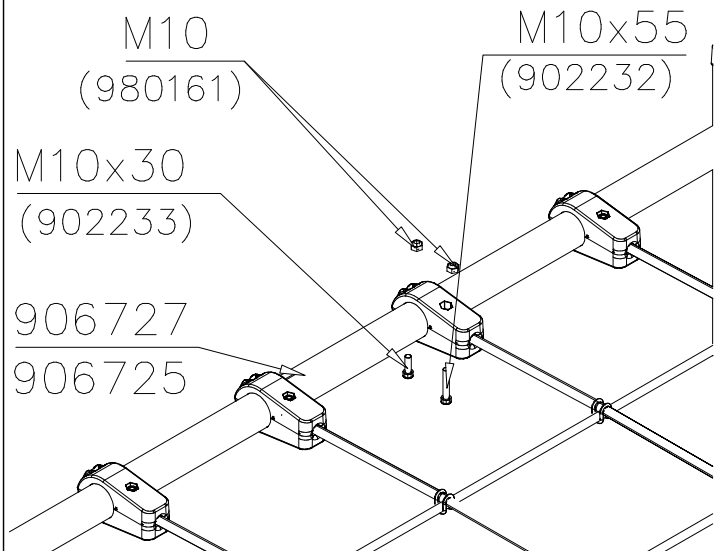

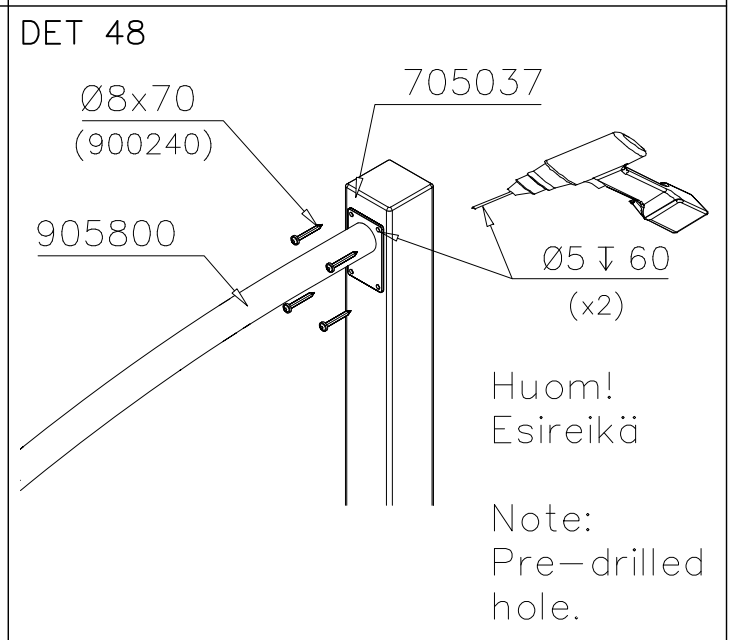
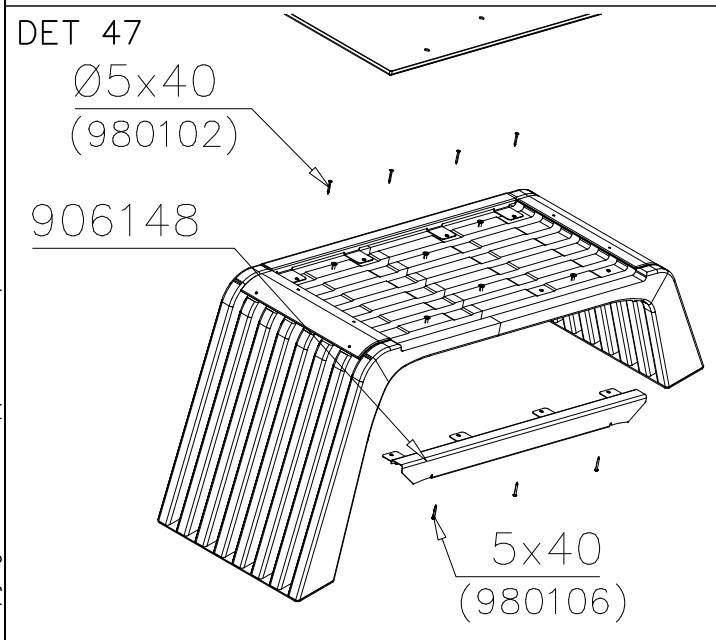
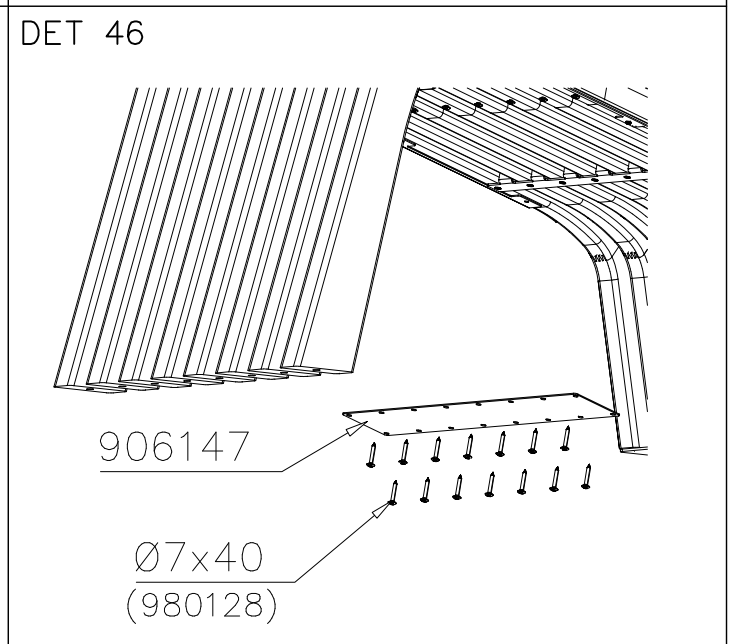
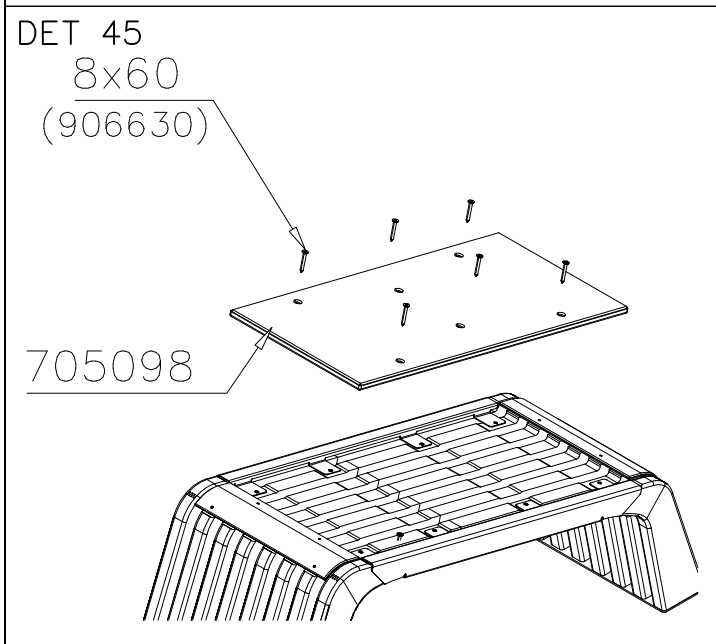
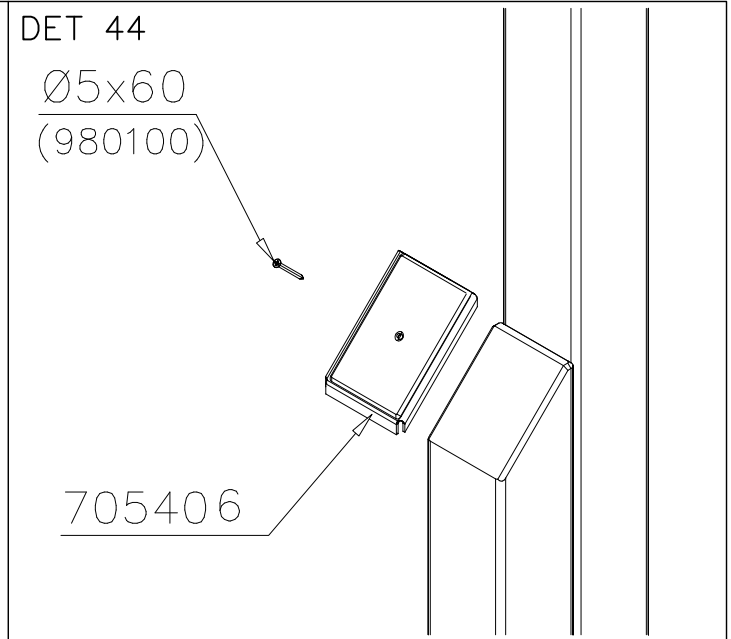
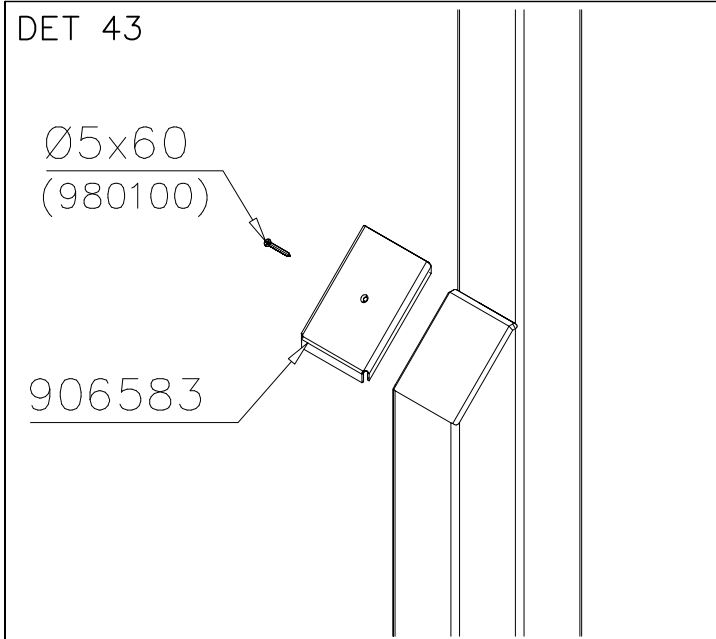

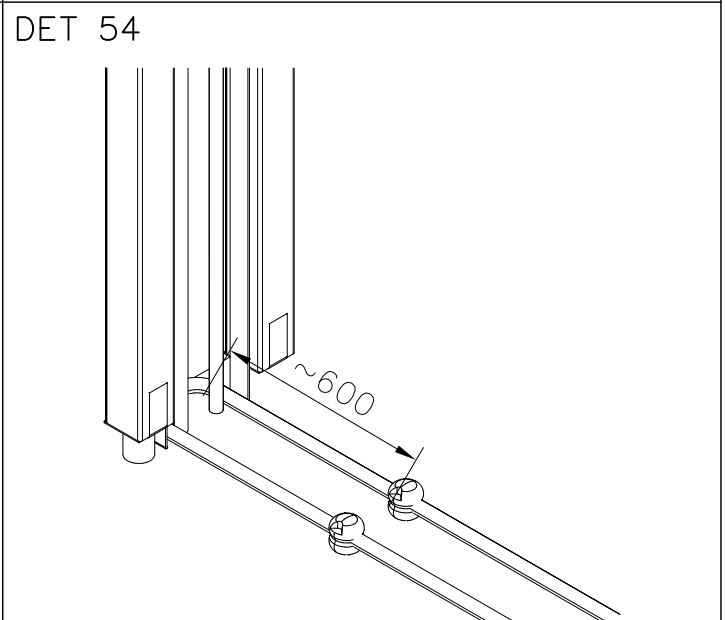
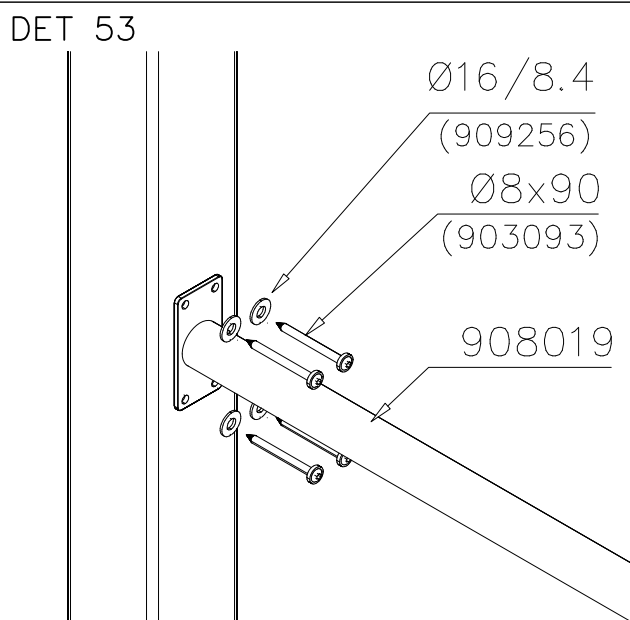
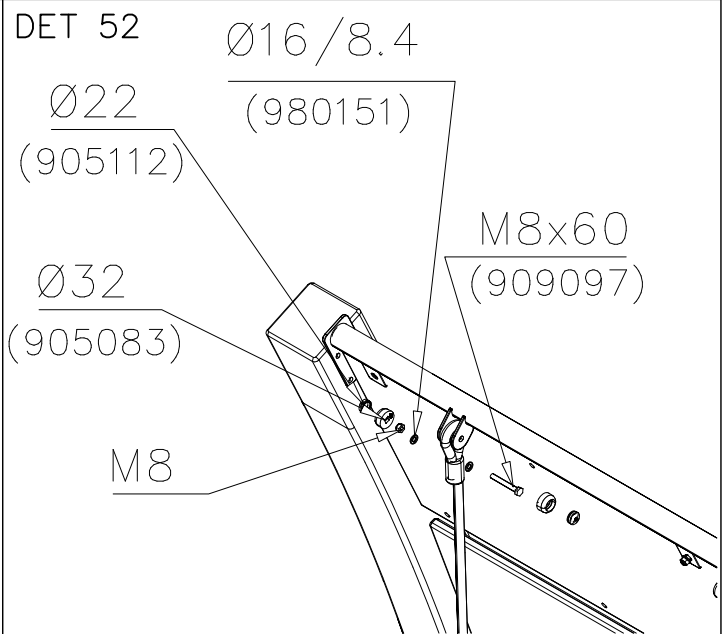
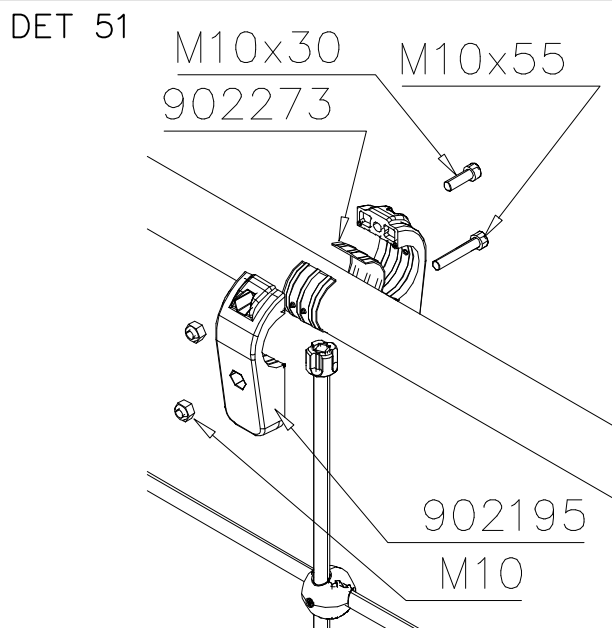
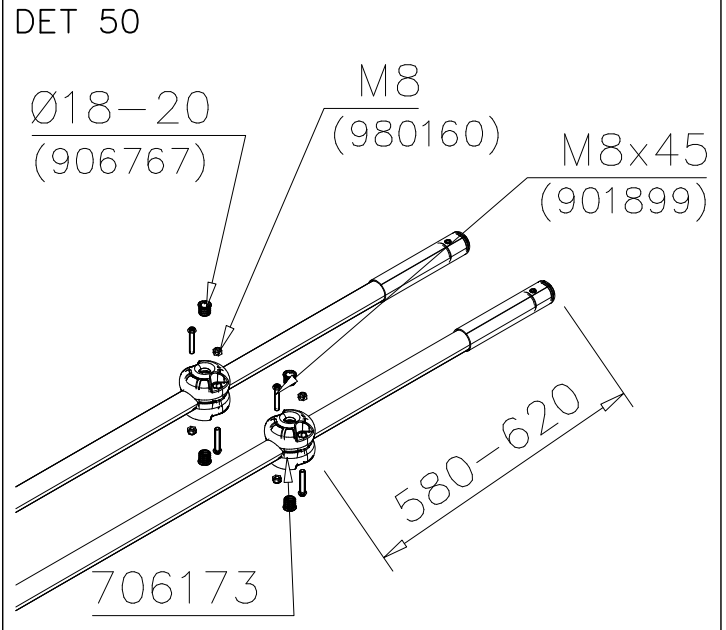
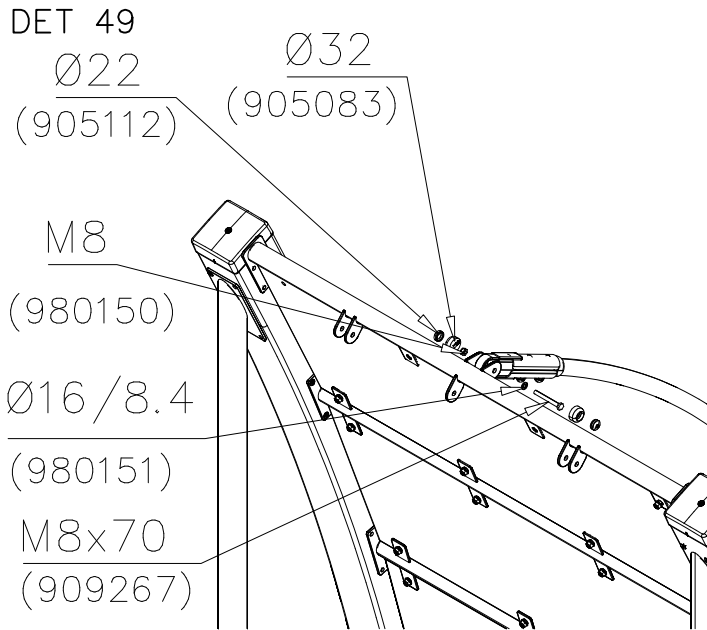

DET 55

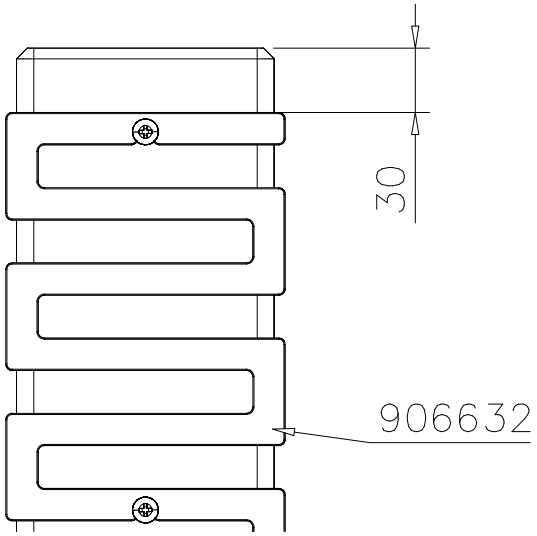

DET 56

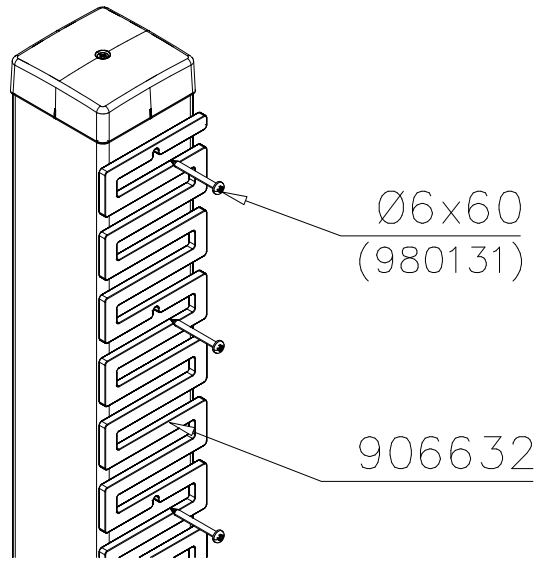

DET 57

DET 58

DET 59

DET 60

DET 1

$\varnothing 16 \downarrow > 130$

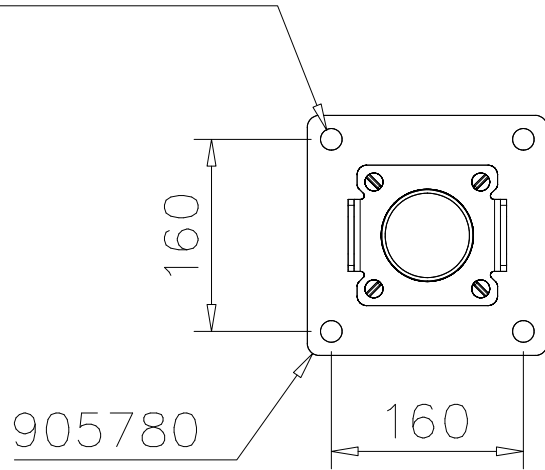

DET 2

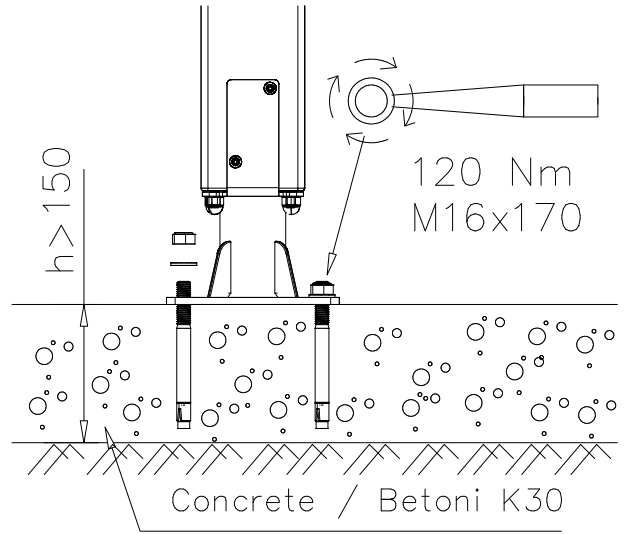

DET 3

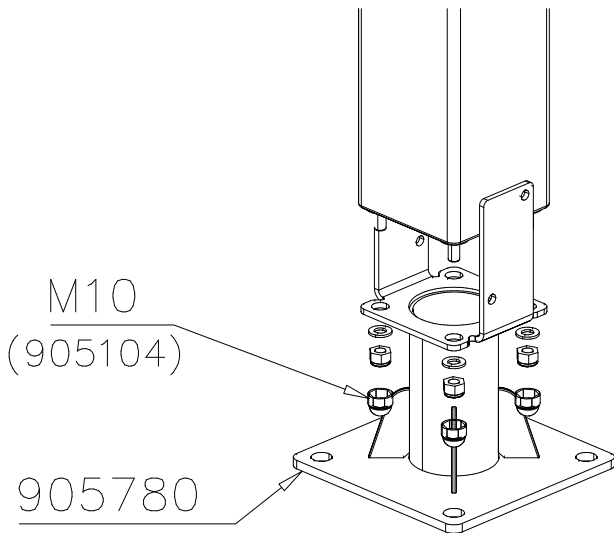

DET 4

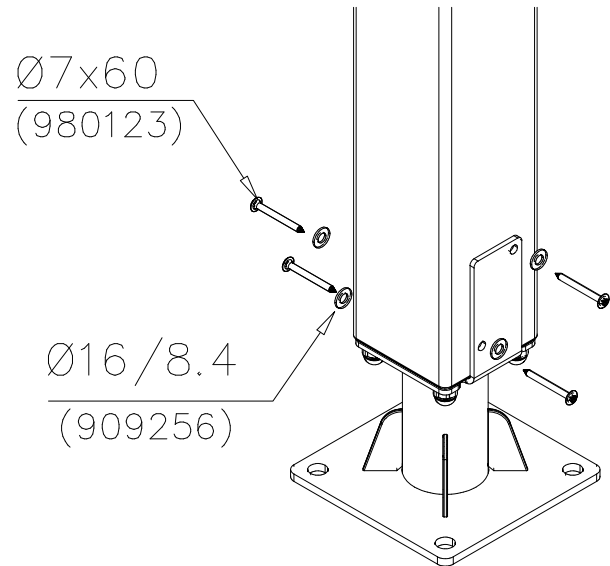

DET 5

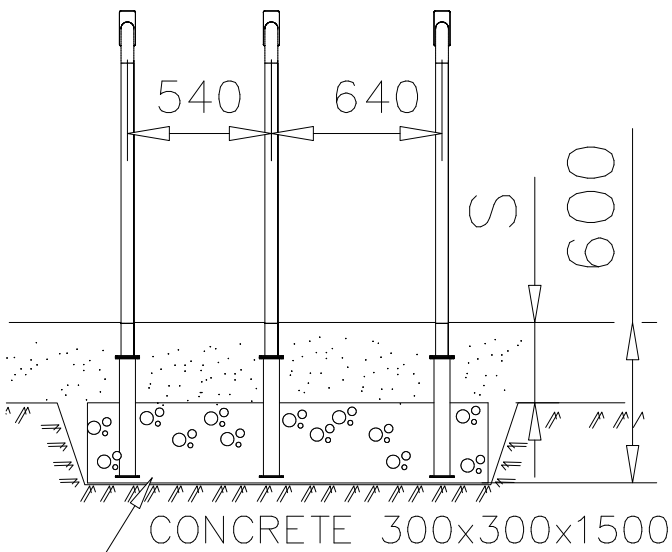

DET 6

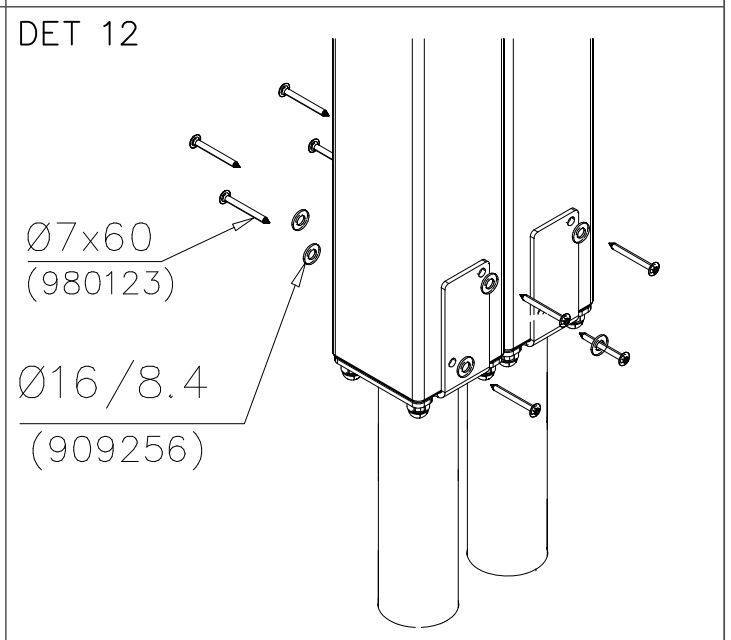
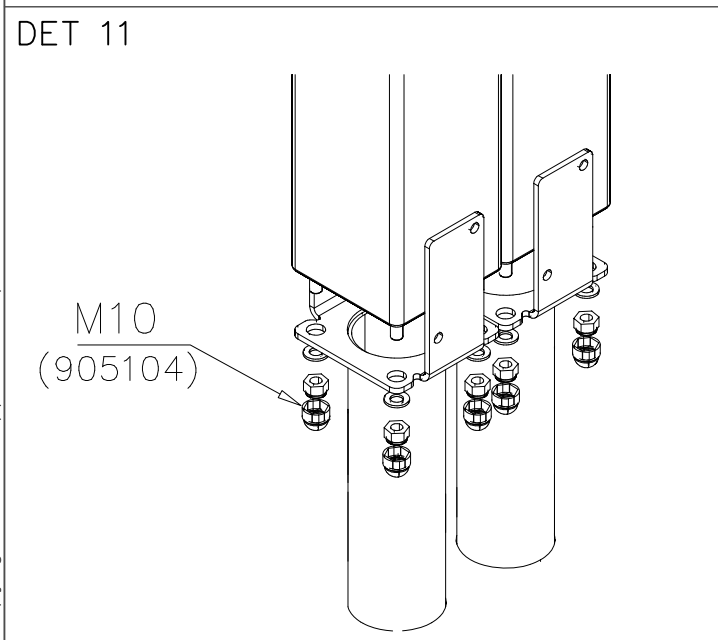
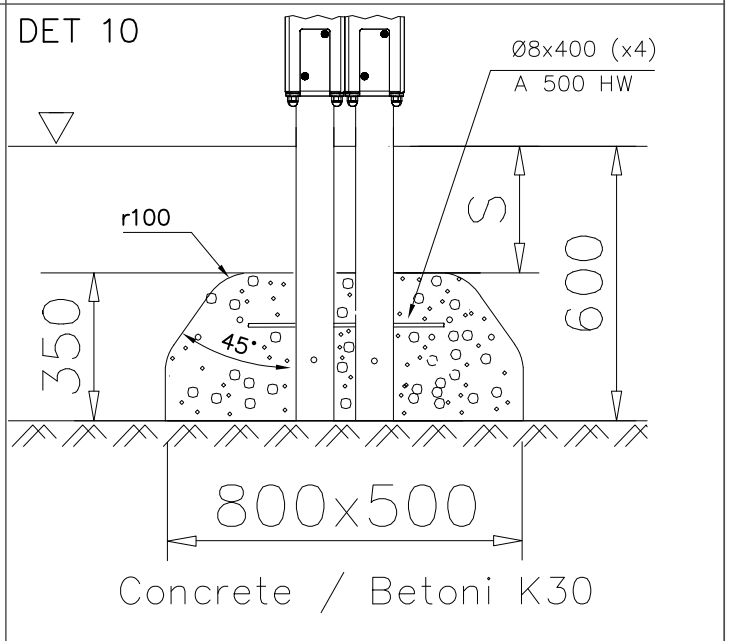
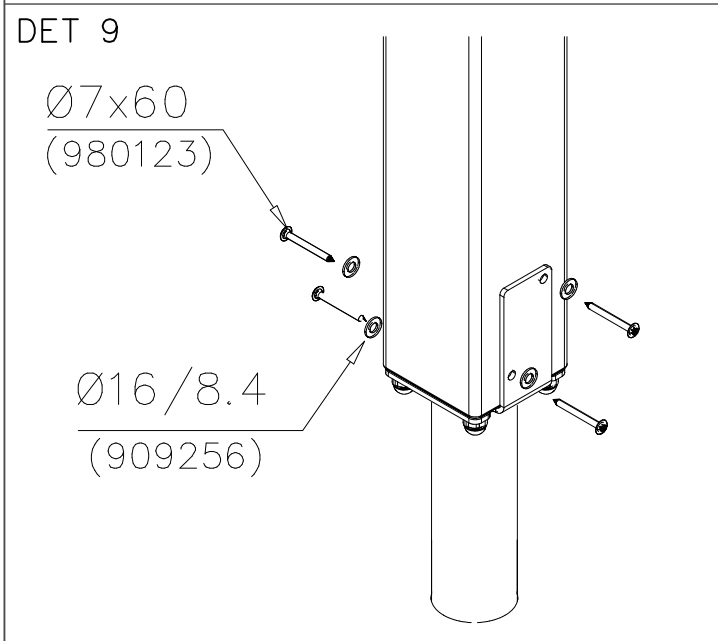
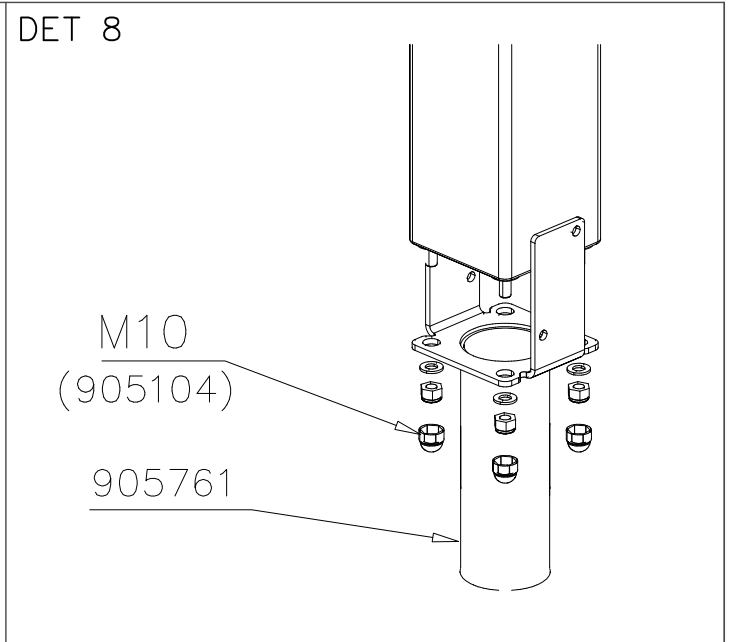
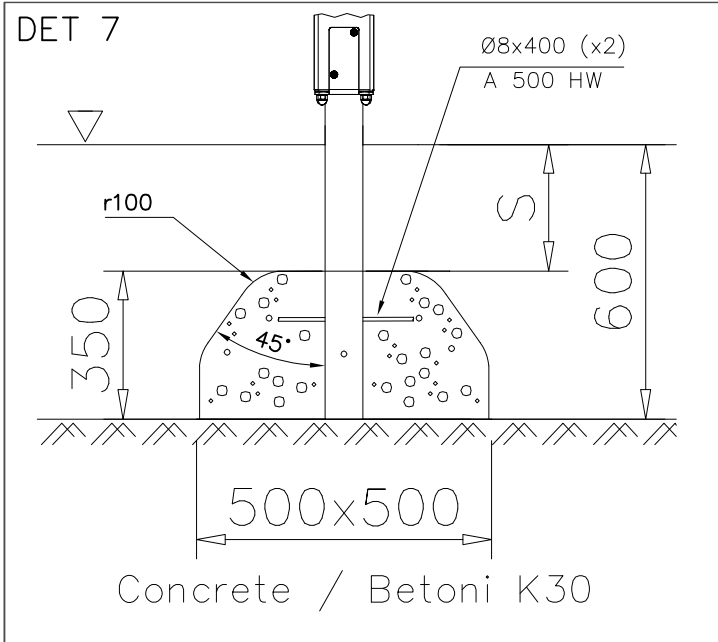



DET 13

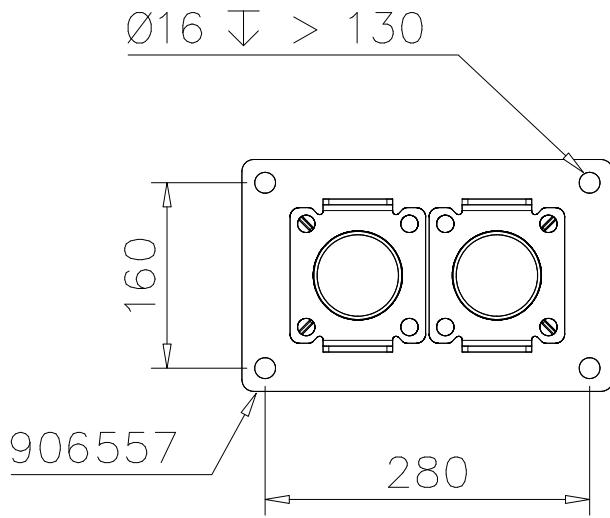

DET 14

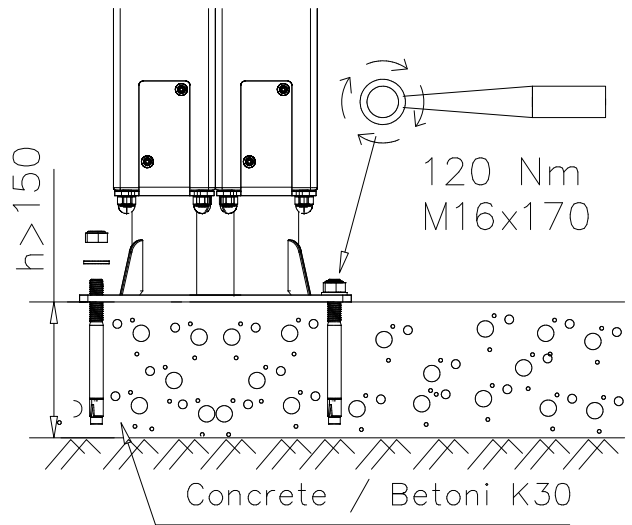

DET 15

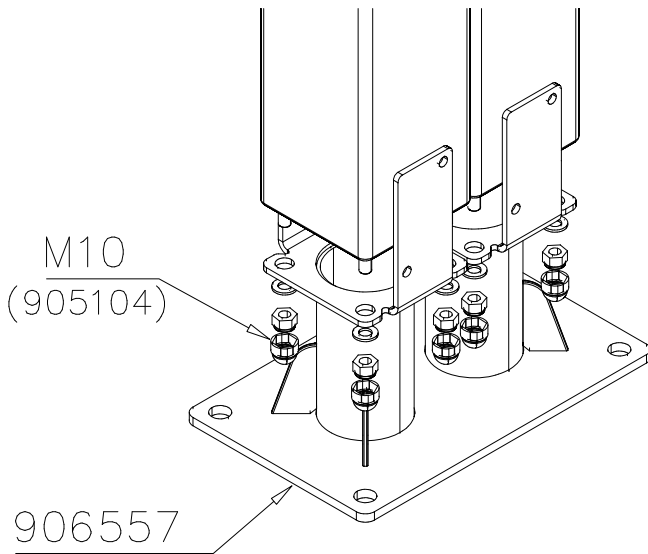

DET 16

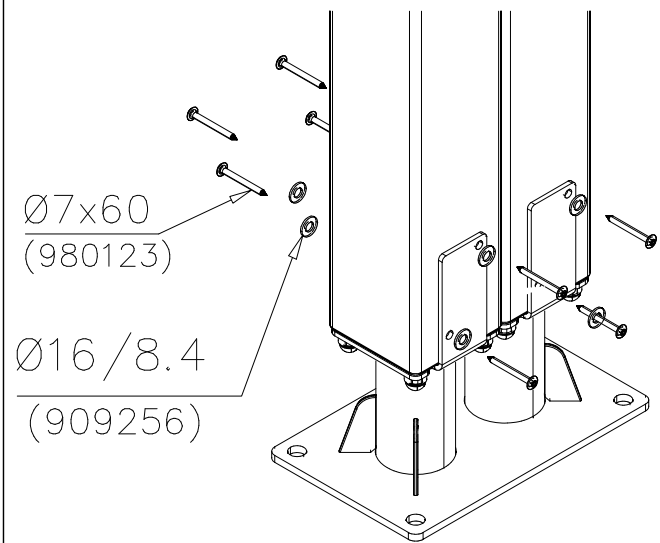

DET 17

DET 18

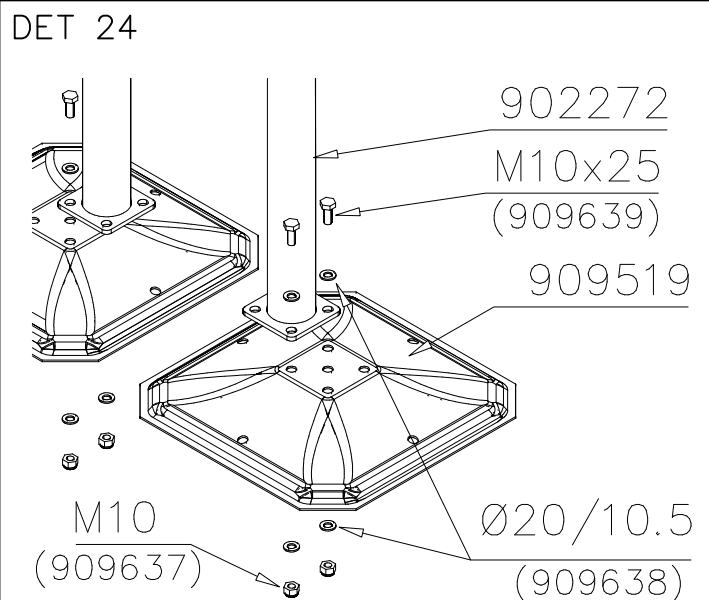
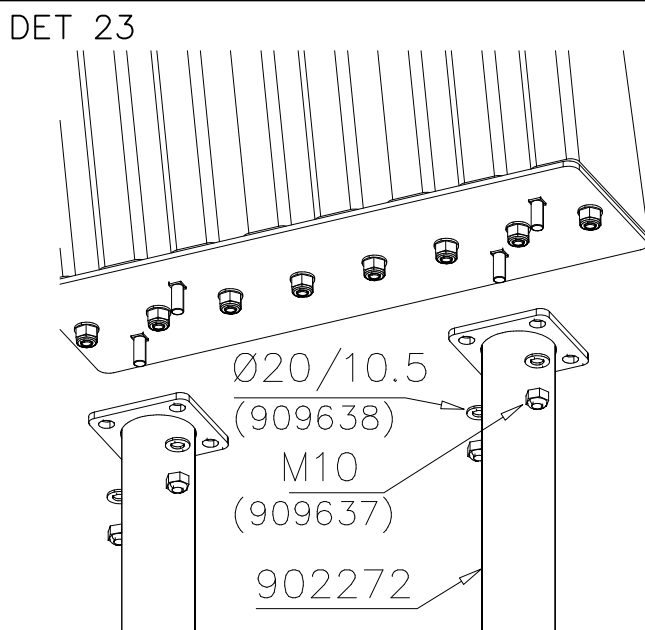
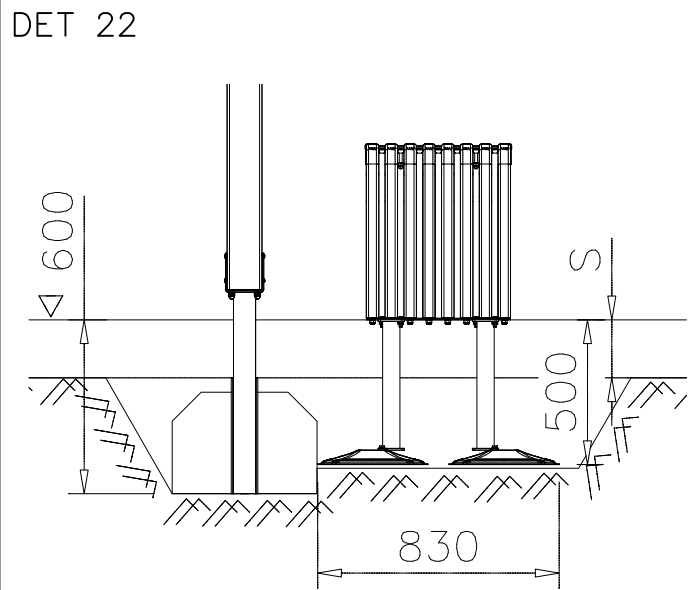
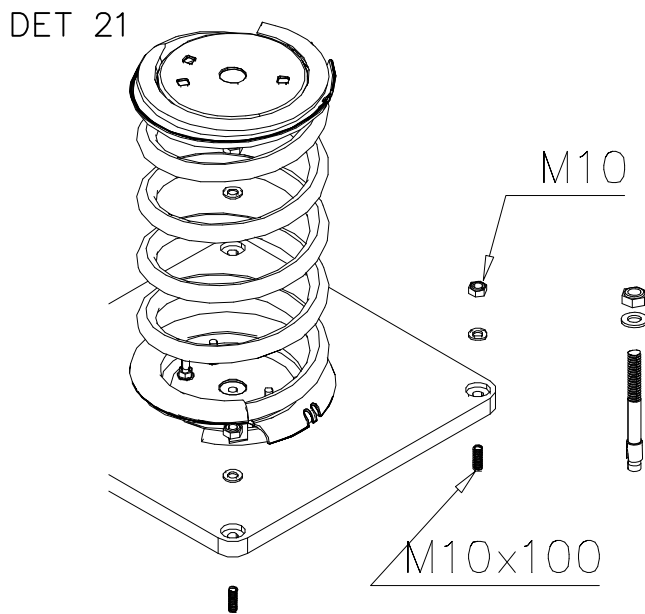
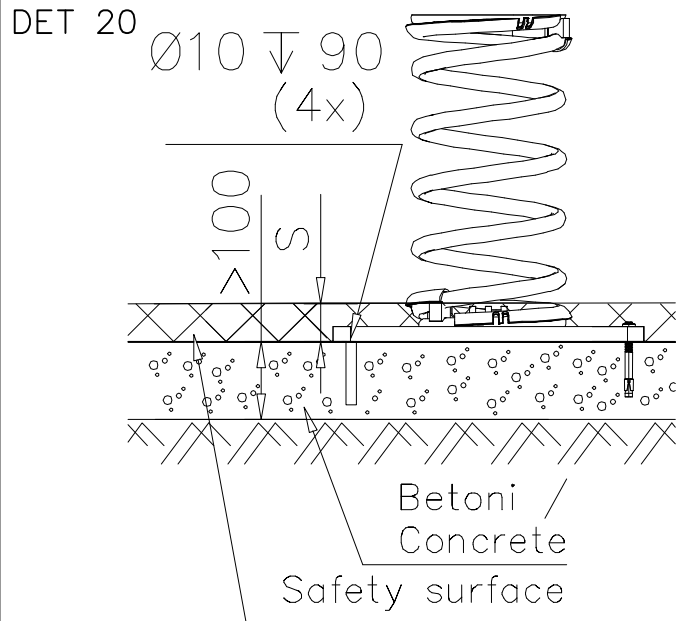
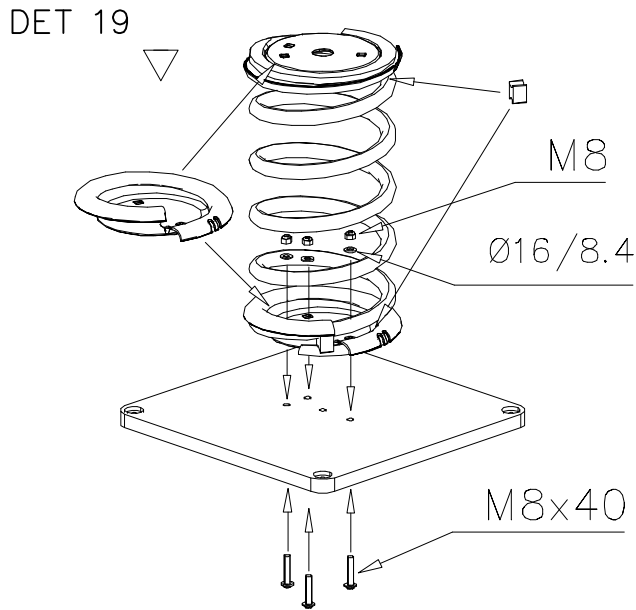

# LAPPSET SPORT

# BASE

DATE: 29.4.2015

5(10)

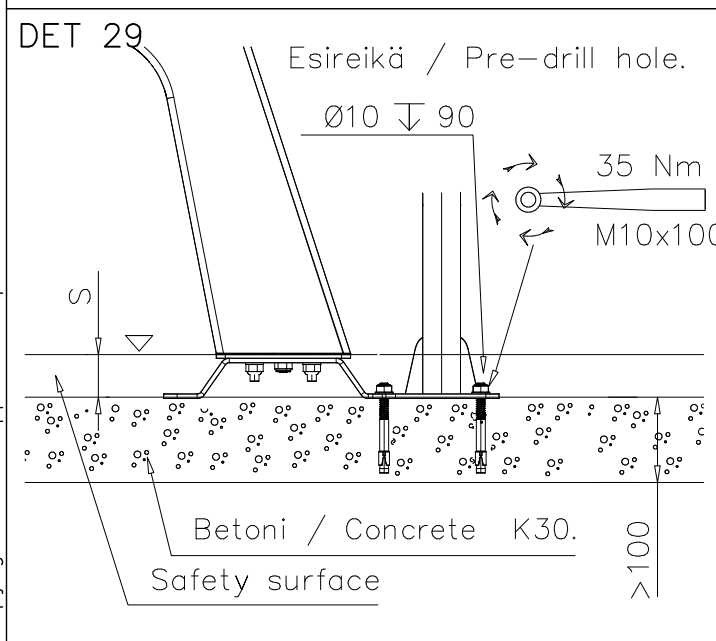
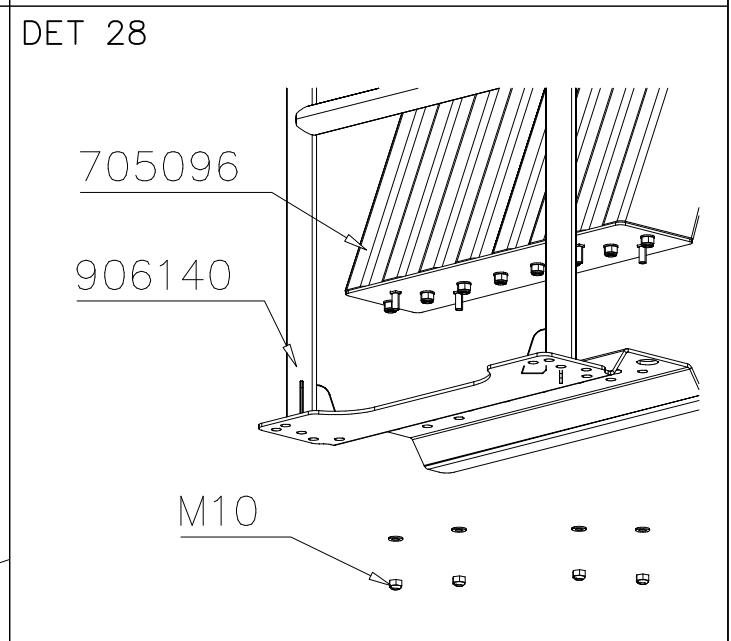
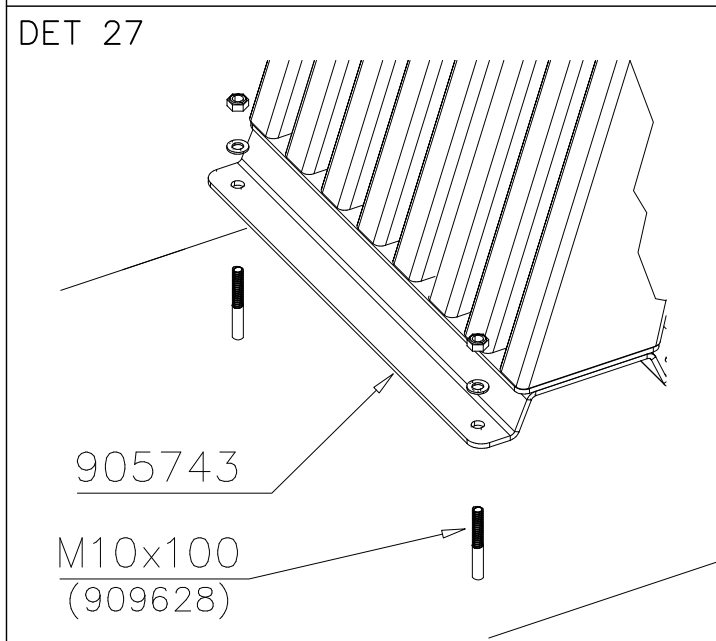
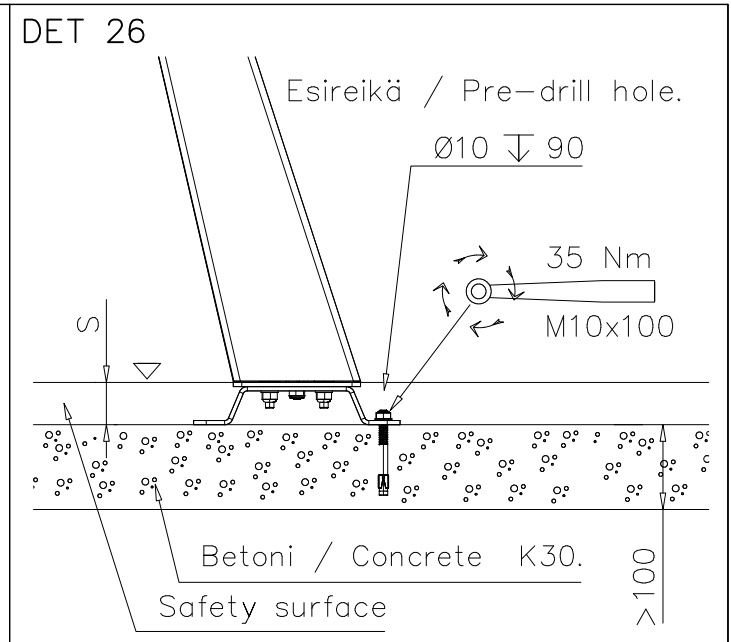
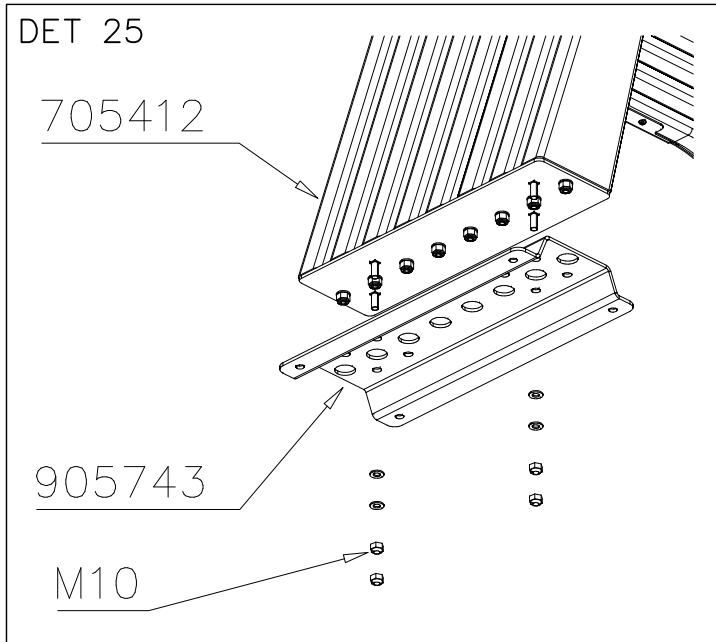

DET 31

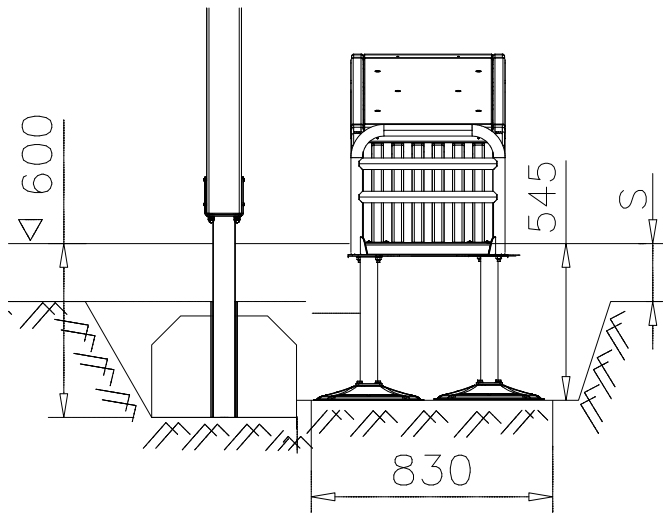

DET 32

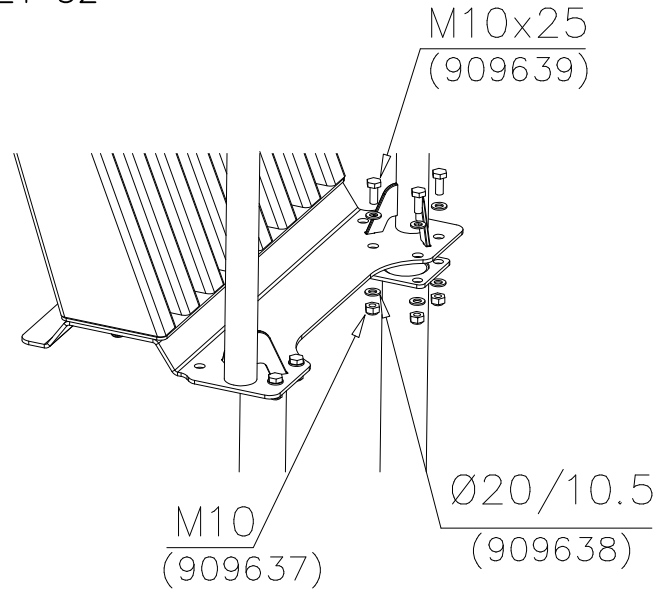

DET 33

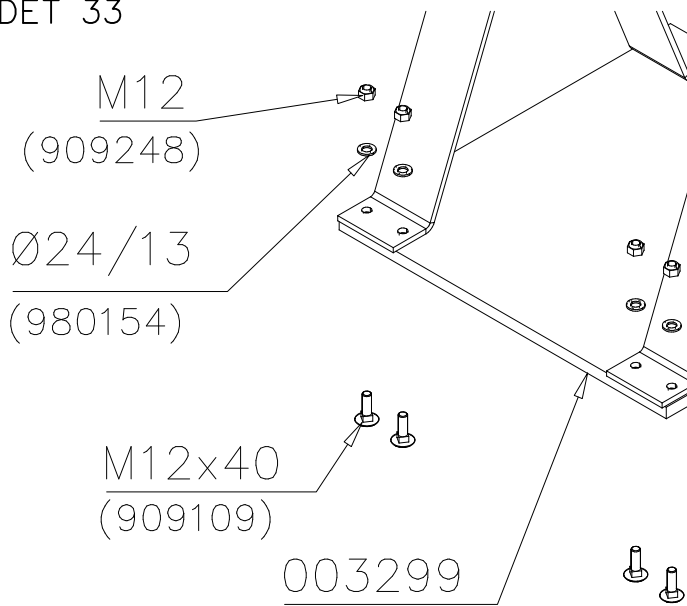

DET 34

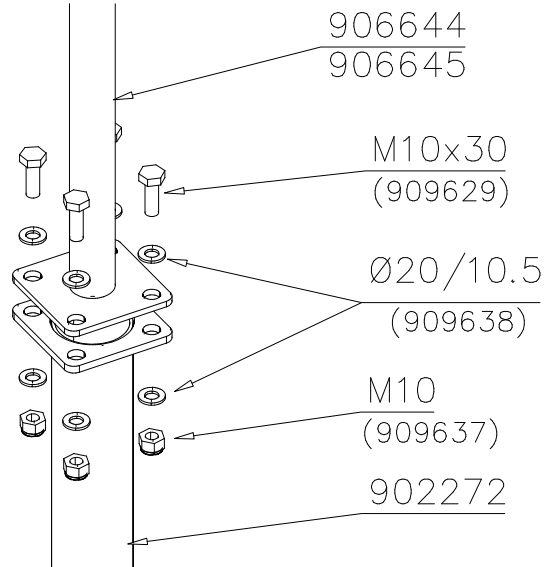

DET 35

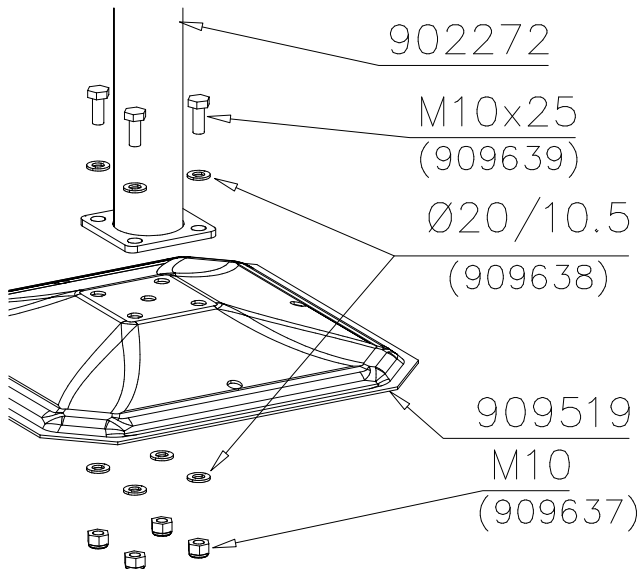

DET 36

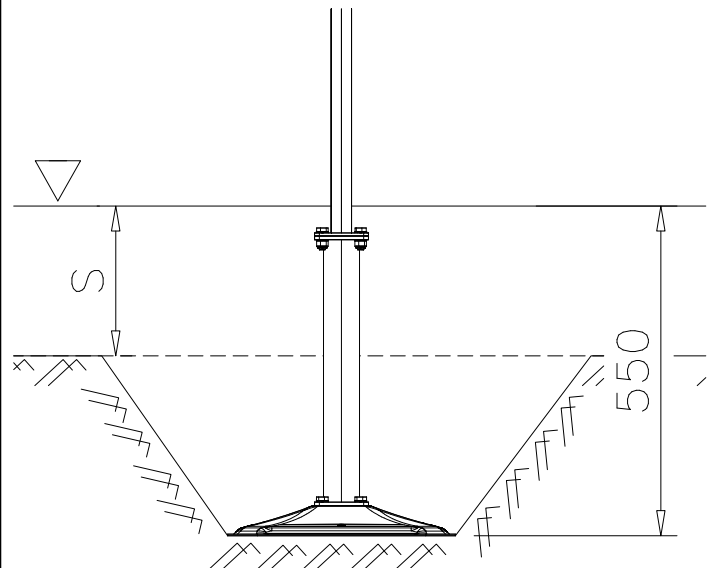

DET 37

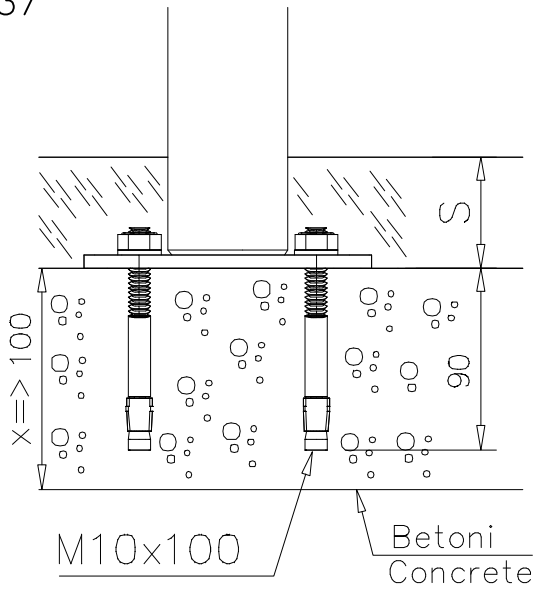

DET 38

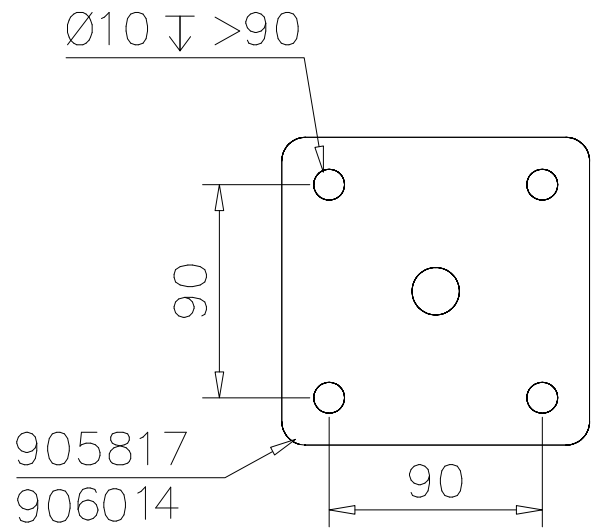

DET 39

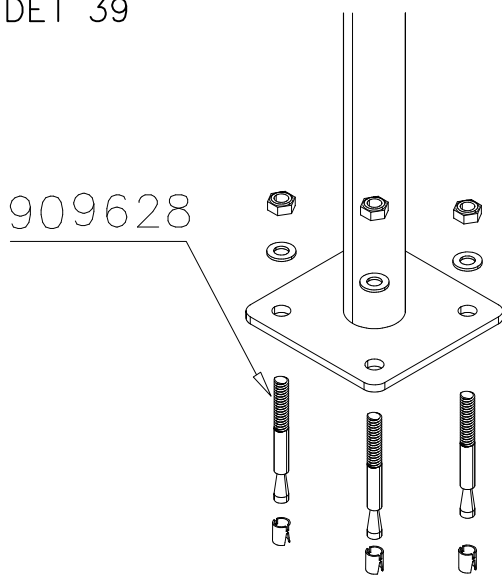

DET 40

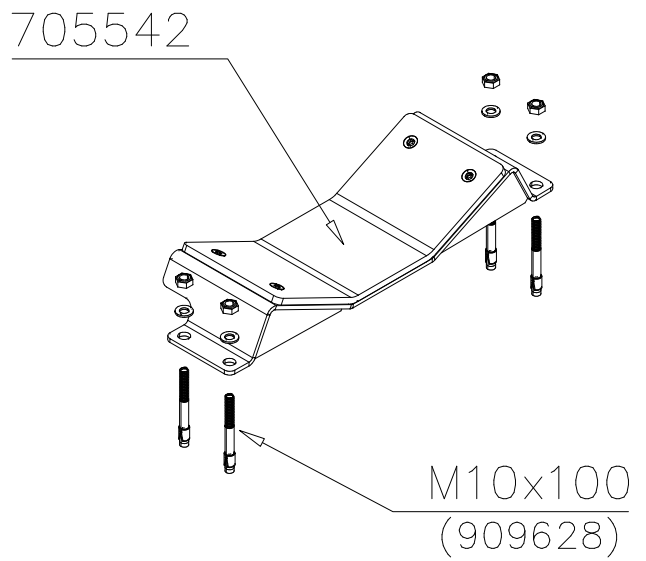

DET 41

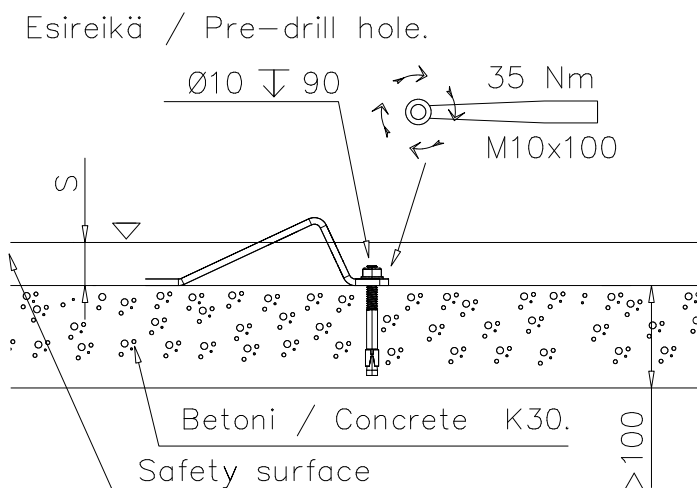

DET 42

# LAPPSET SPORT

# BASE

DATE: 15.8.2017

8(10)

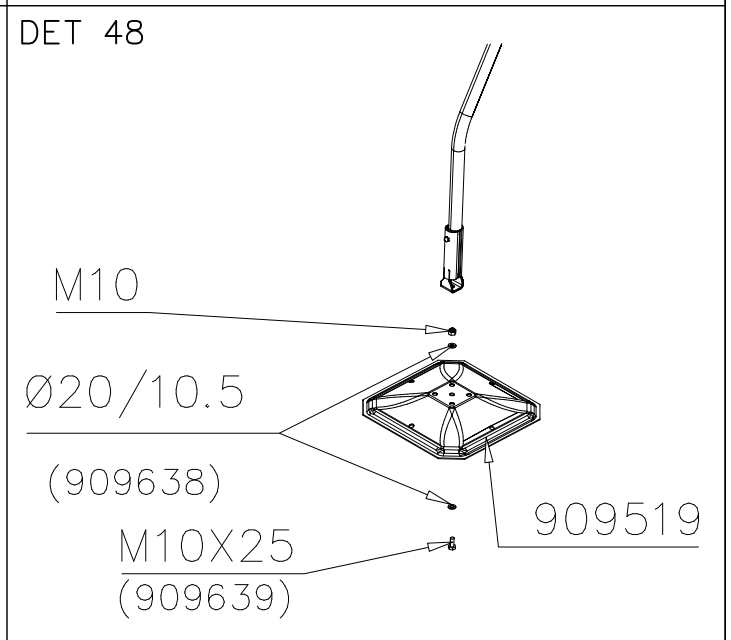
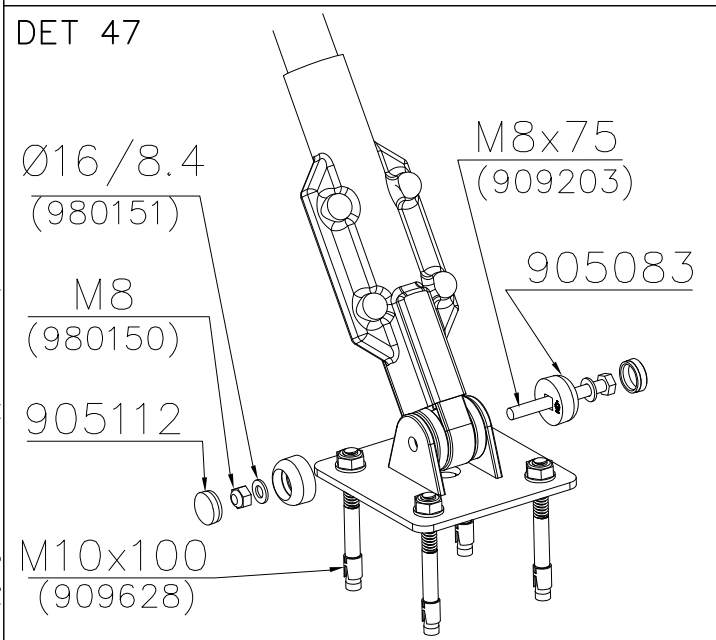
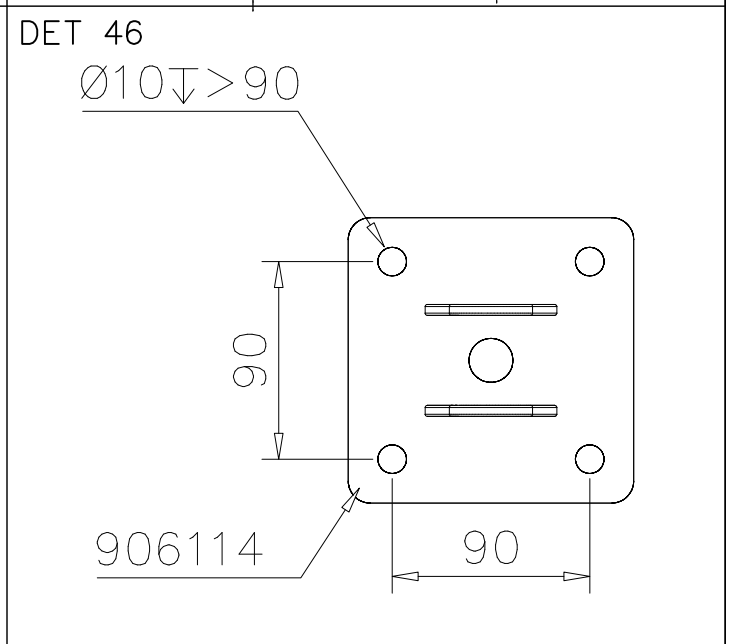
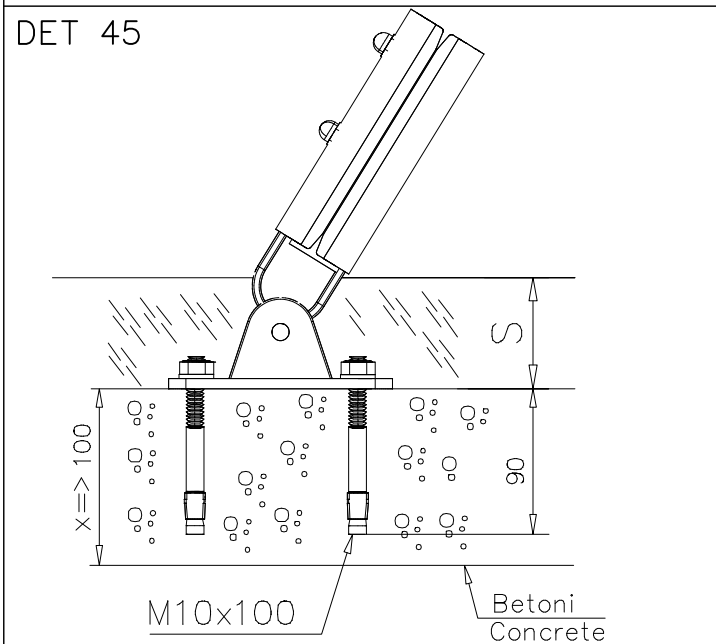
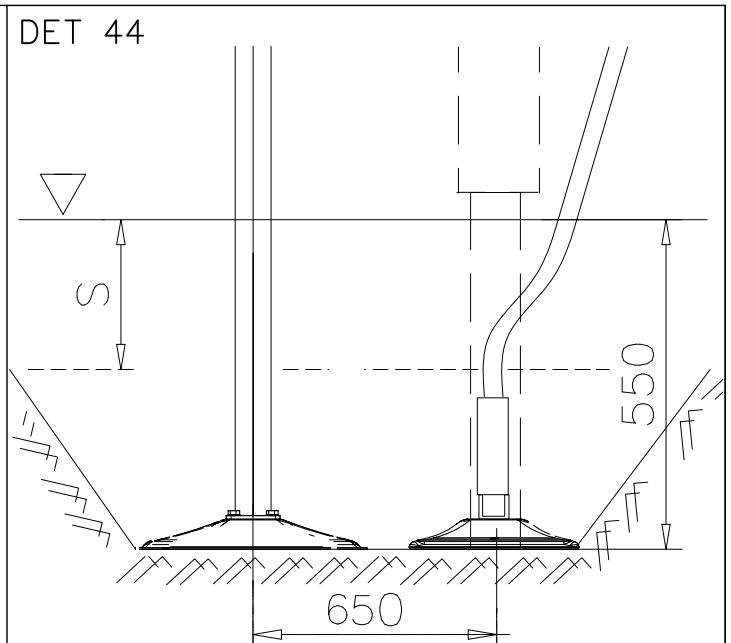
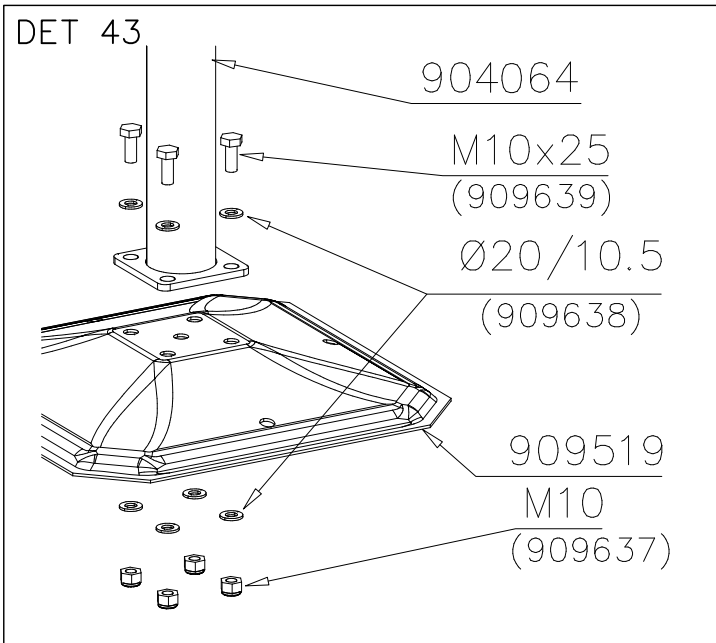

DET 49

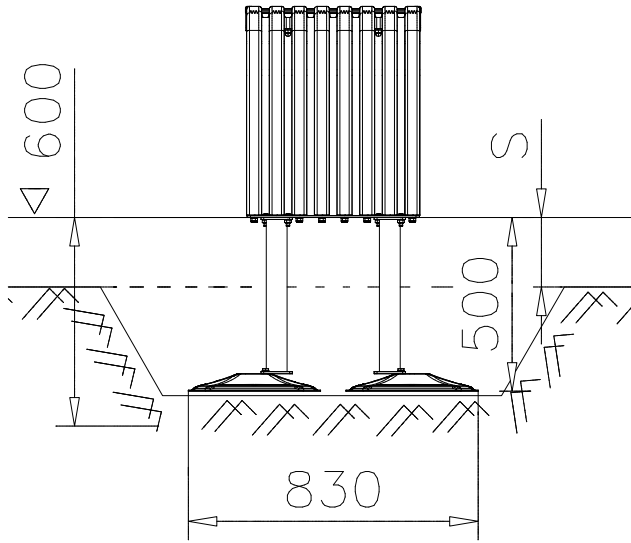

DET 50

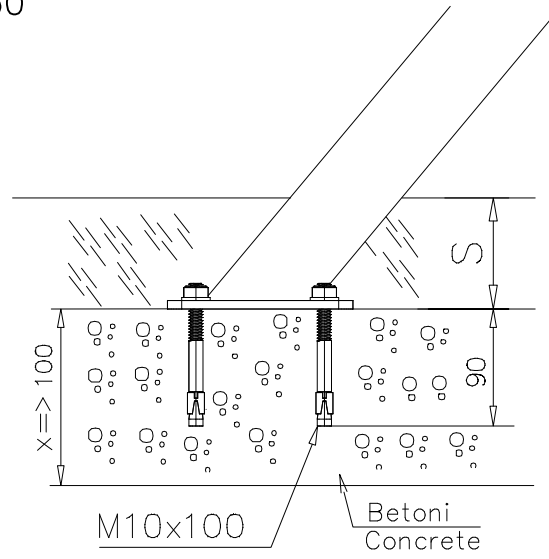

DET 51

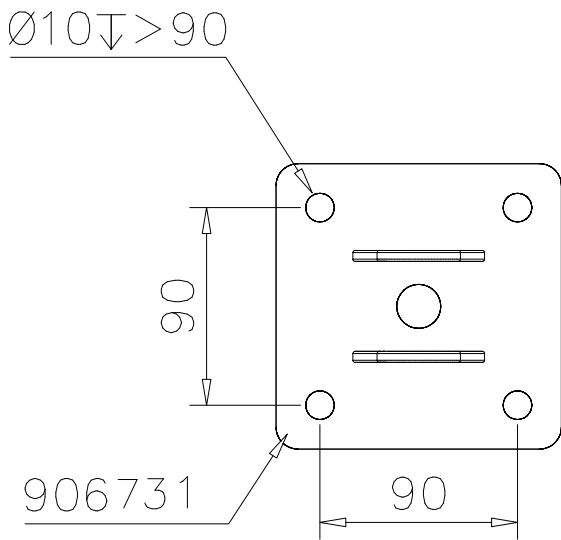

DET 52

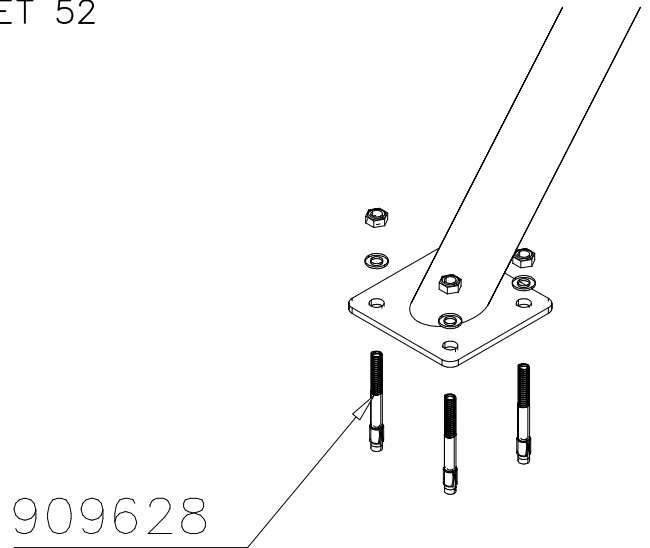

DET 53

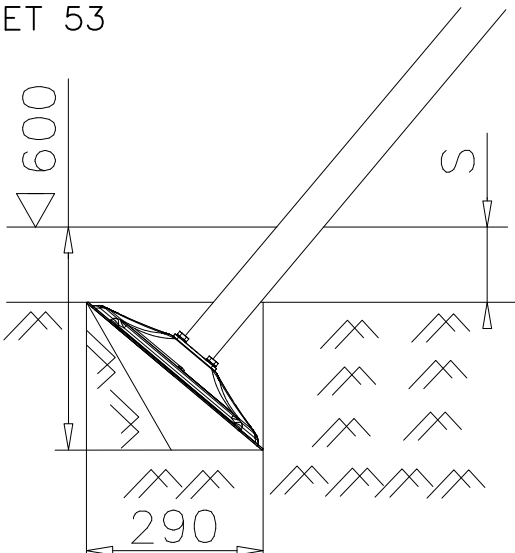

DET 54

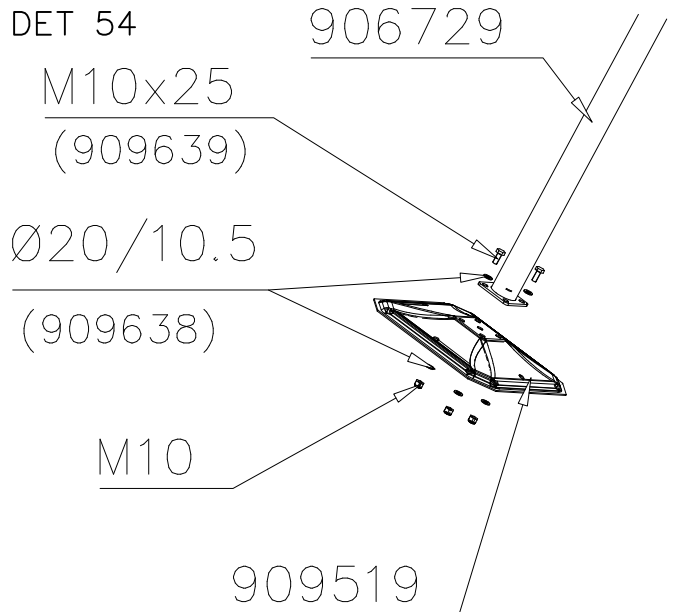

DET 55

STEELNET Ø6 #150  
(1400x2100)  
Concrete  
1500X2200X200 K30

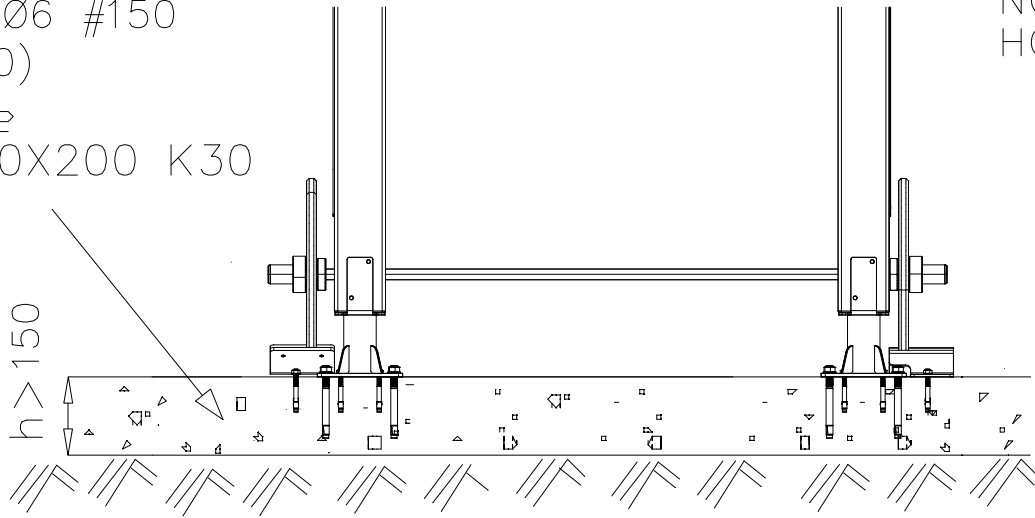

NOTE!  
HOX!

DET 56

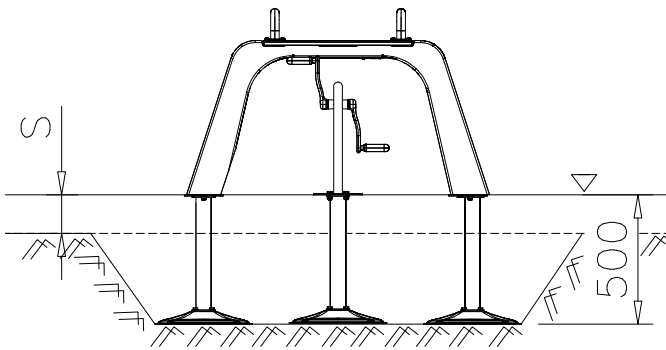

DET 57

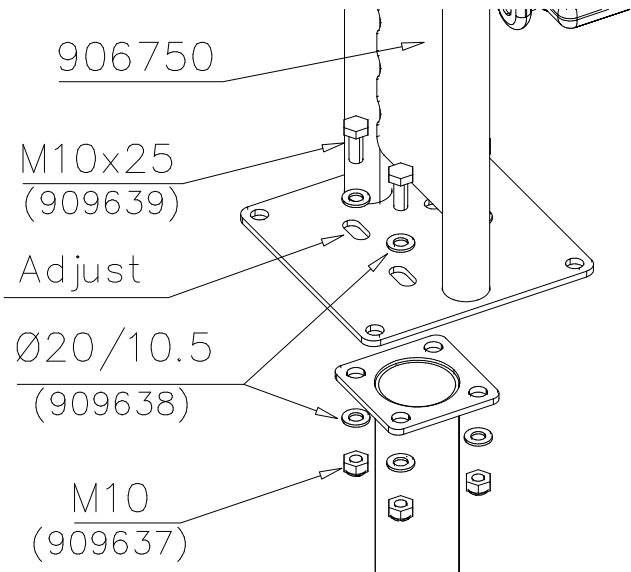

DET 58

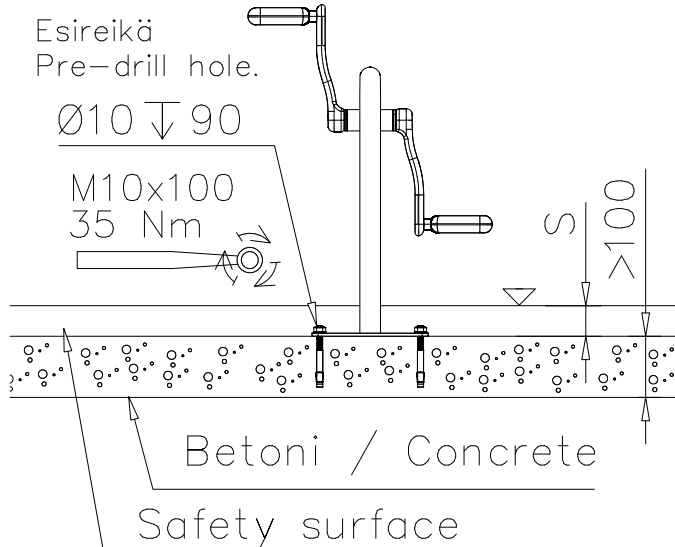

DET 59

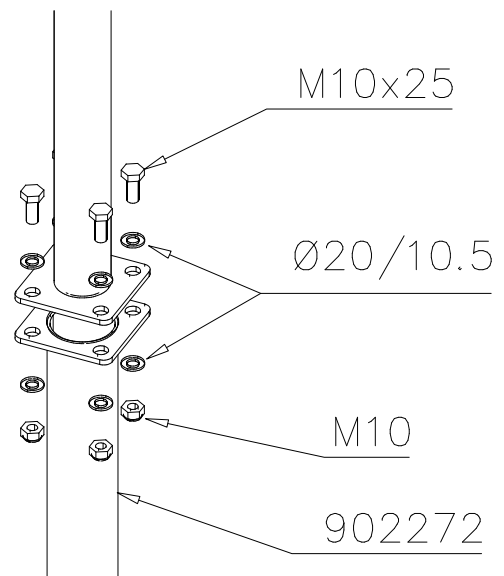



① SHEET METAL	PCS	② 980114	PCS
	1		4
118x78x0.7		Ø4x20	

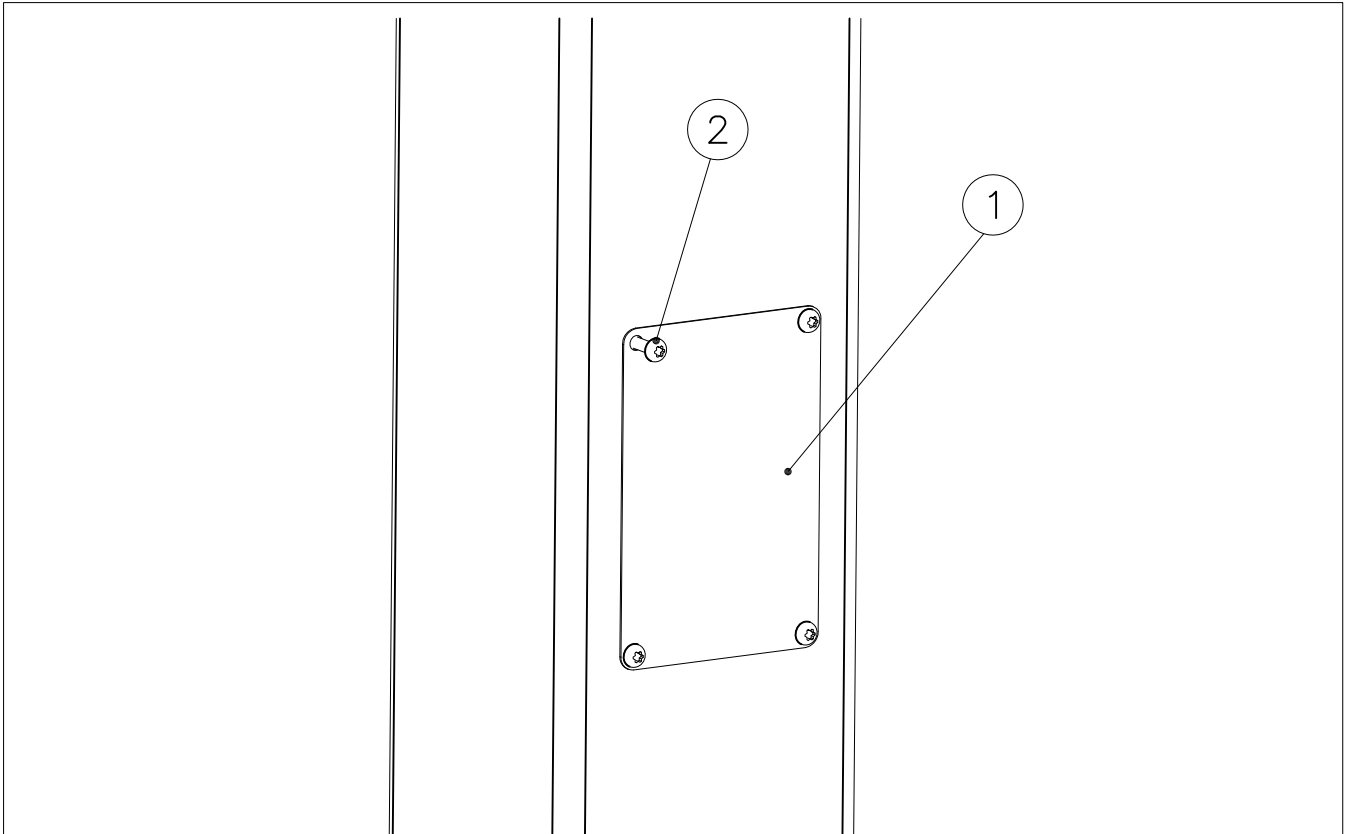

Example installation !  
Esimerkki asennus !

Example installation !  
Esimerkki asennus !

Example installation !  
Esimerkki asennus !



Example installation !  
Esimerkki asennus !

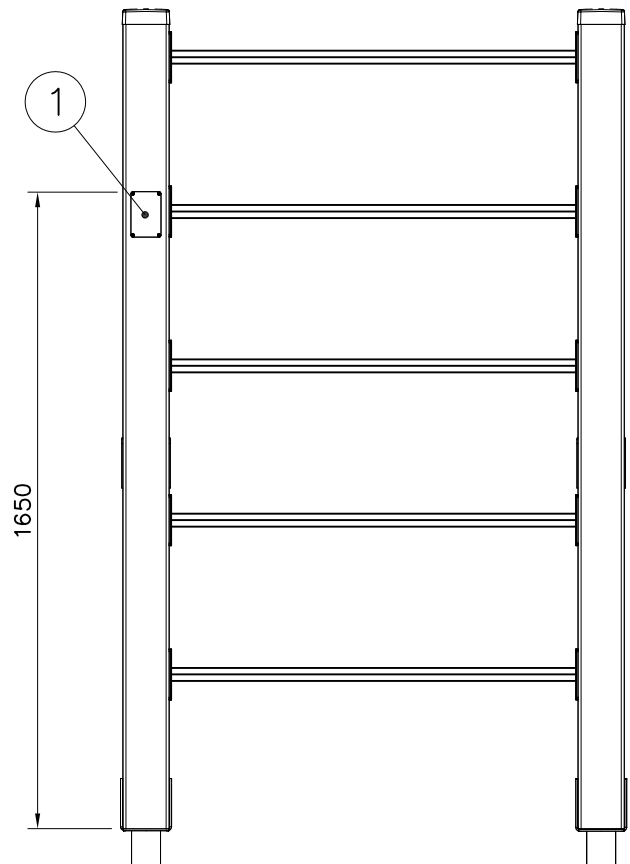

Example installation !  
Esimerkki asennus !