

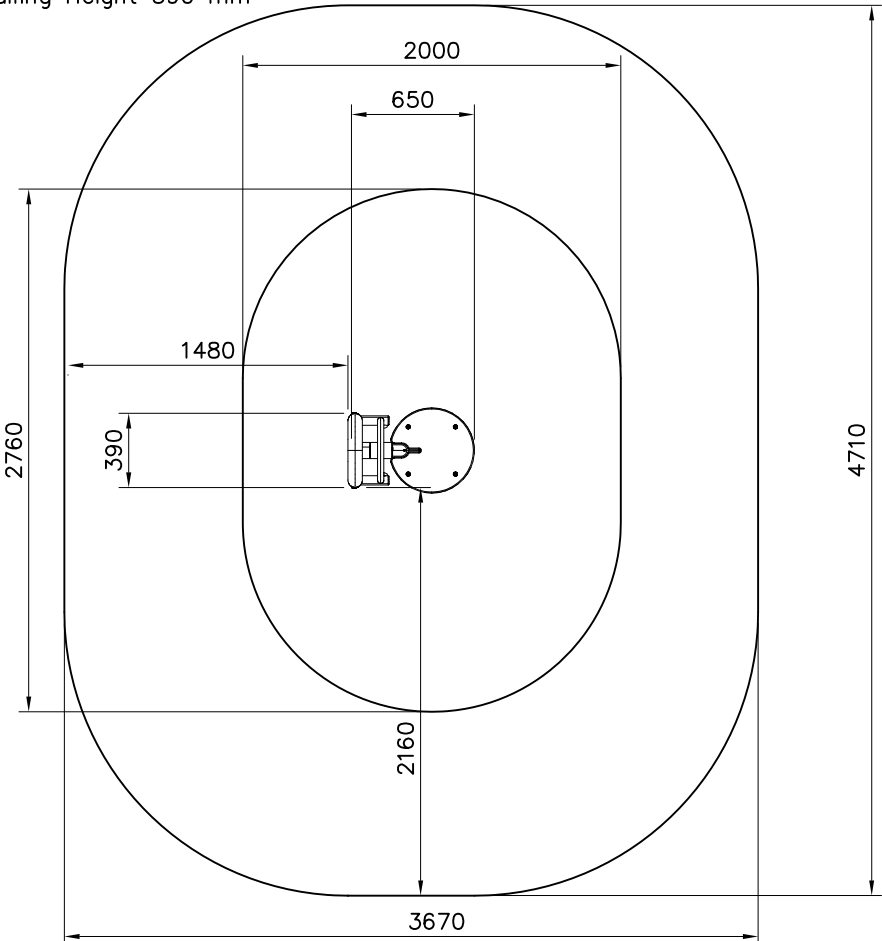

Area of Movement 15.4 m2
Training Space 4.7 m2
Max Falling Height 590 mm

1: 40



① 904450	PCS		PCS
	4		
M16x170			
	PCS		PCS
			1
	PCS		PCS
	PCS		PCS
	PCS		PCS
	PCS		PCS
	PCS		PCS

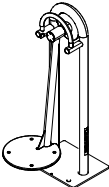
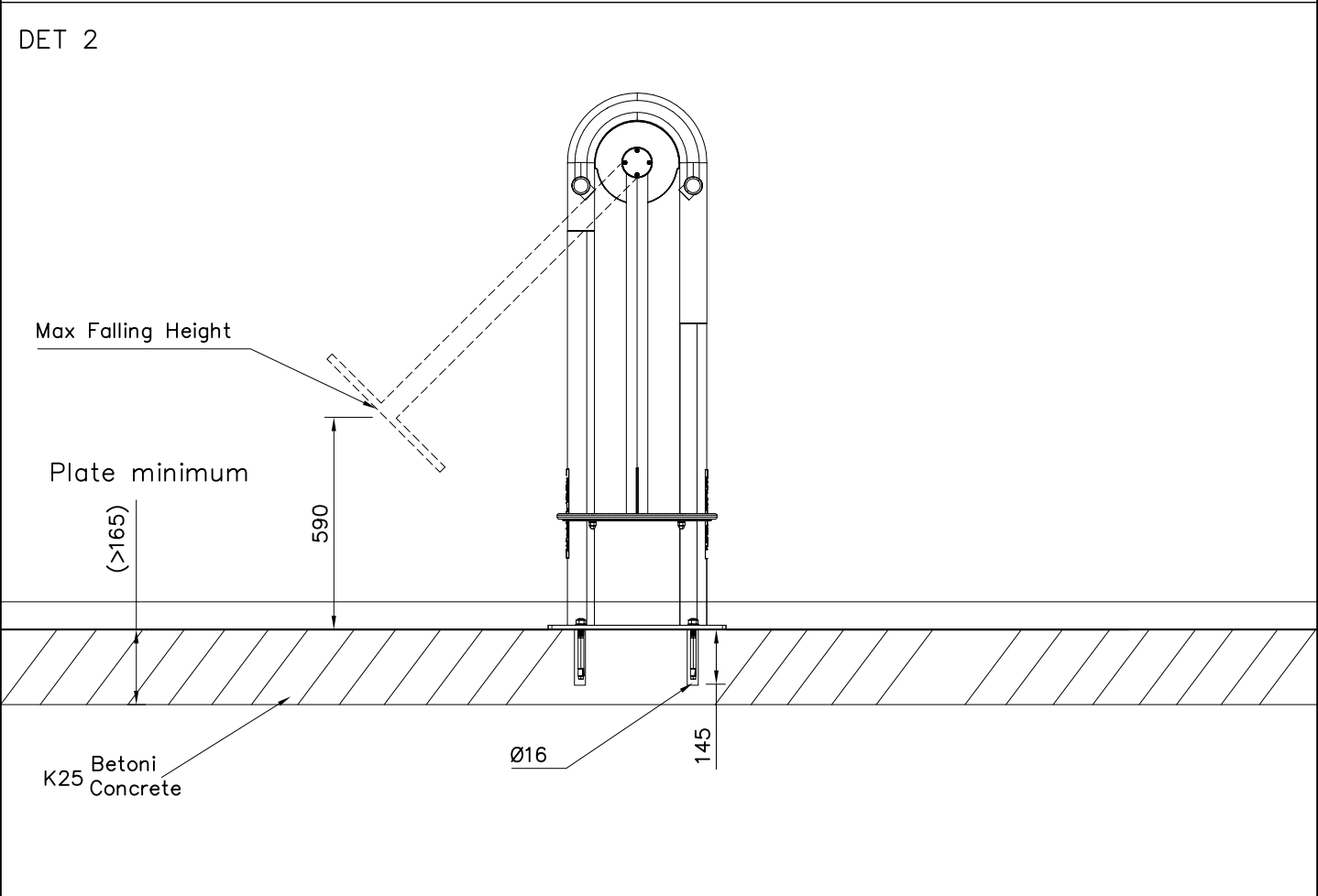
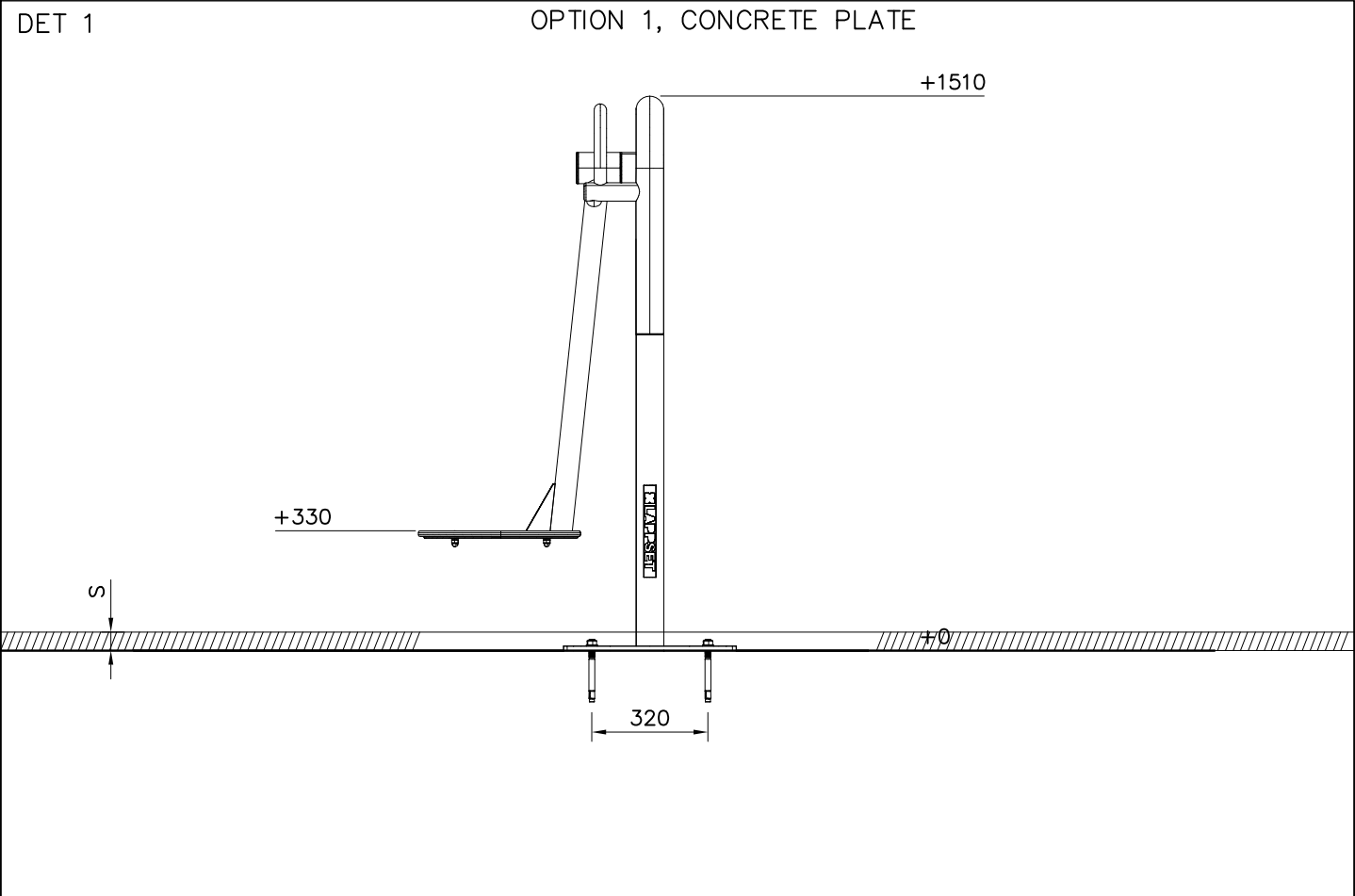

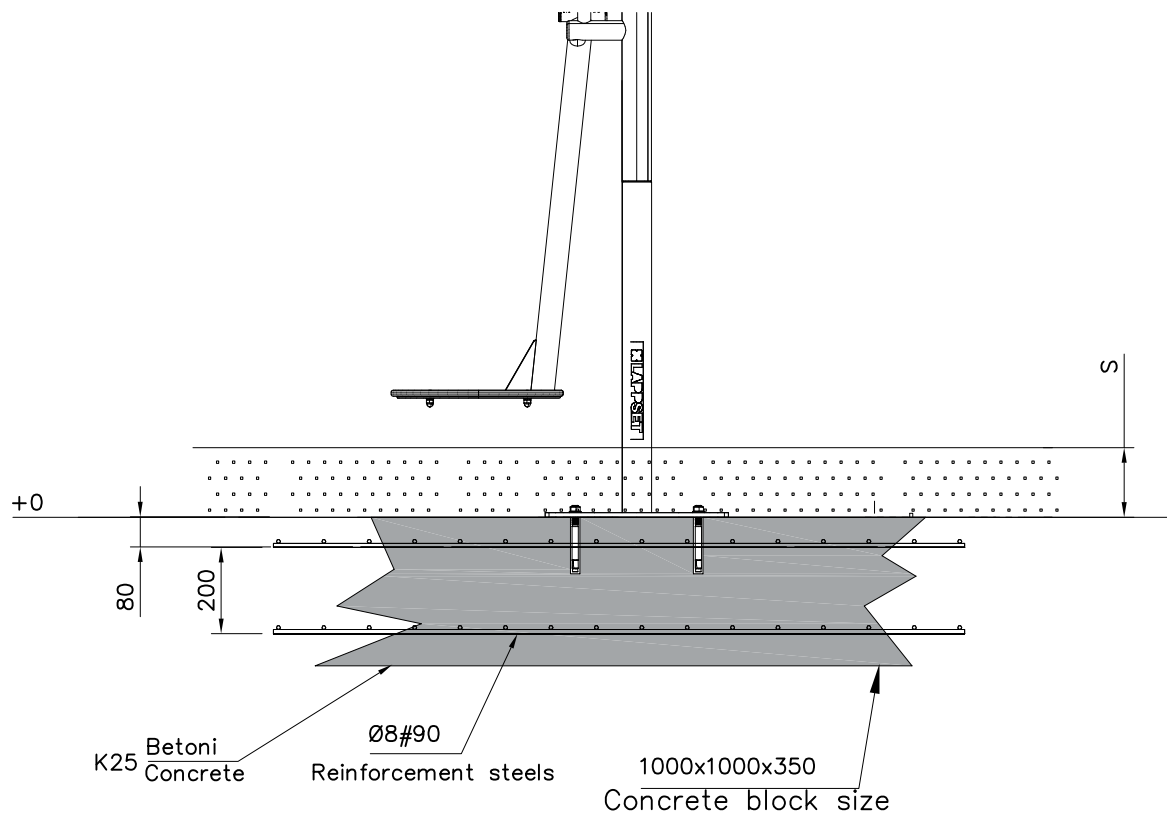

DET 1

OPTION 2, CONCRETE BLOCK

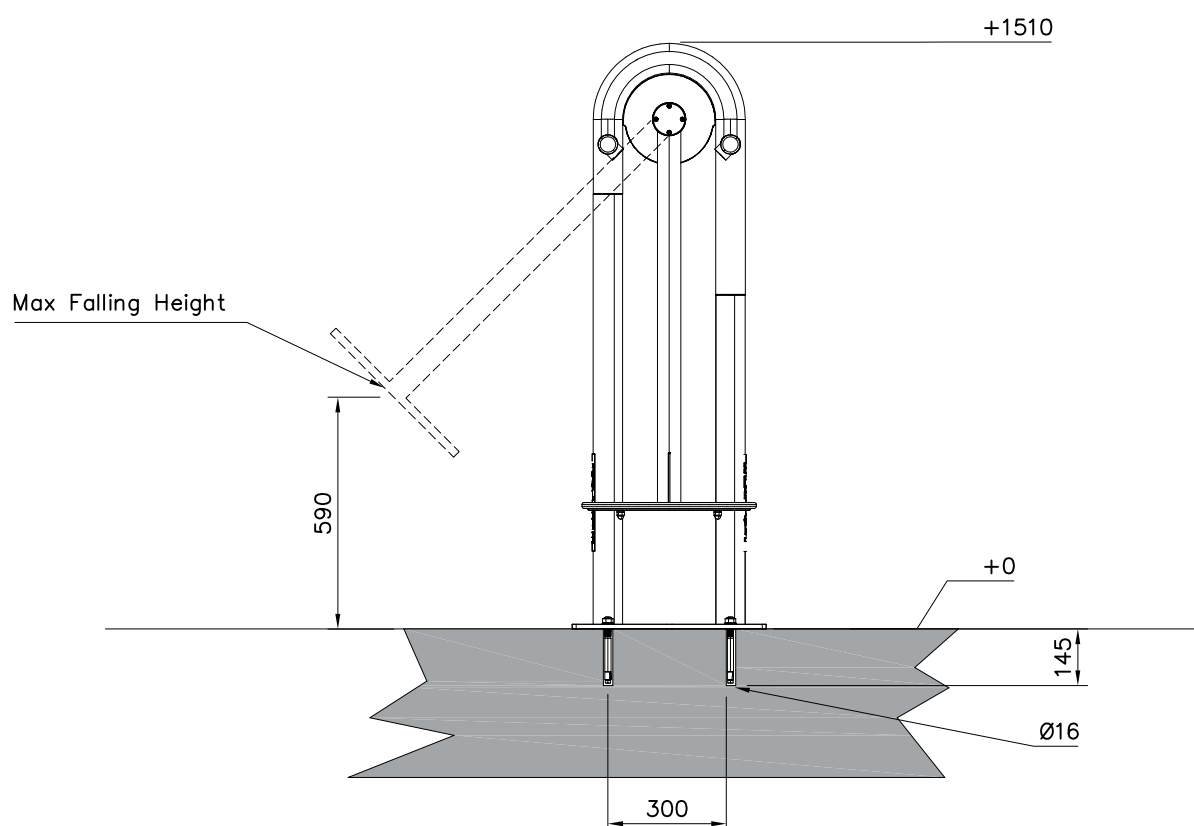

DET 2

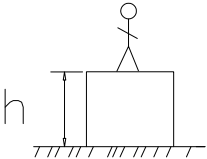
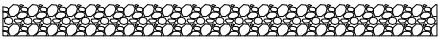

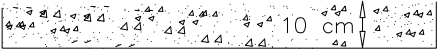
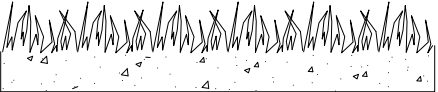
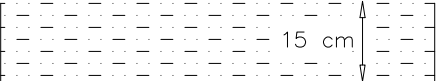
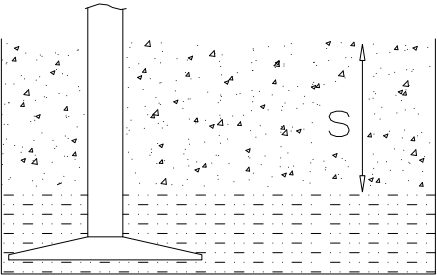
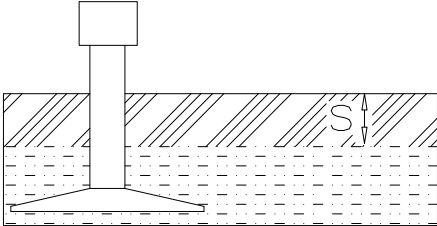

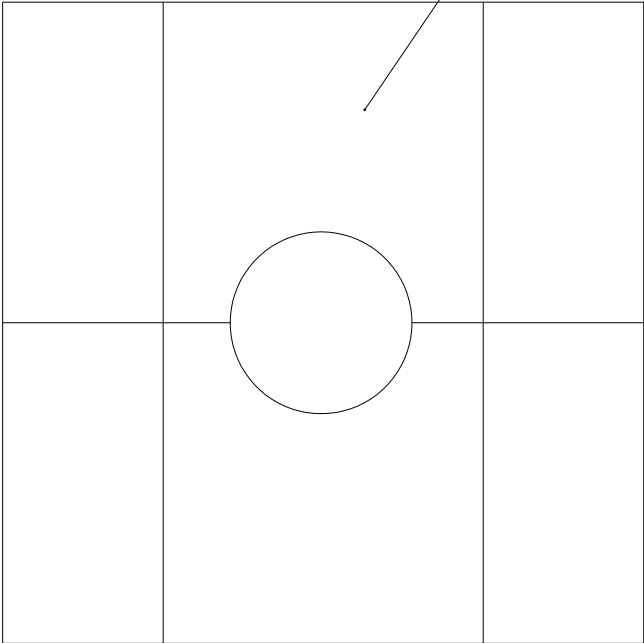

		
<div><div>h < 600</div><div>Without movement and therefore without Impact Area</div></div>	Totally hard surfaces. Note. Lappset does <u>not recommend</u> totally hard surfaces at all.	E.g. concrete or asphalt 
<div><div>h < 600</div><div>With movement e.g. rocking</div></div>	Materials with very limited impact attenuating properties.	E.g. wood 
<div><div>h < 1000</div></div>	Materials with significant impact attenuating properties.	<div><div>fine gravel 0–8 mm </div><div>grass </div><div>unsorted sand </div></div>
<div><div>h < 3000</div></div>	<div>Loose fill material E.g. sand/gravel 0,25...8 mm D60/D10<3,0 Woodchips 5...30 mm bark 20...80 mm</div>	<div> <div><div><u>S</u> 30 cm 40 cm</div><div><u>h</u> < 2,0 m < 3,0 m</div></div></div>
	<div>Syntethic granulates <div><div><u>S</u> 40 mm ~> 1,2...1,3 m 50 mm ~> 1,5...1,7 m 60 mm ~> 1,8...2,0 m 70 mm ~> 2,1...2,5 m</div><div>Note. For accurate values, see manufacturer's instructions.</div></div></div>	

REMOVE SAFETY SURFACE/SAND/GRAVEL
TO CHECK FOUNDATION

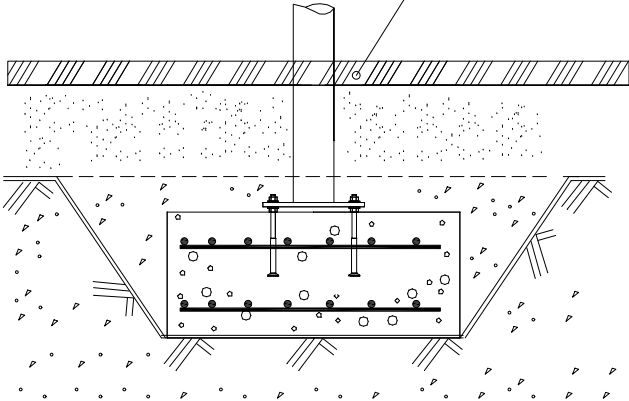

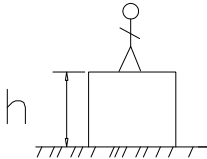
REMOVE SAFETY SURFACE/SAND/GRAVEL
TO CHECK FOUNDATION

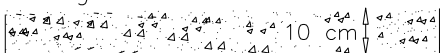

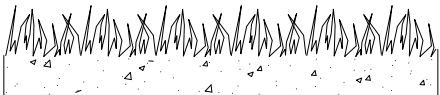
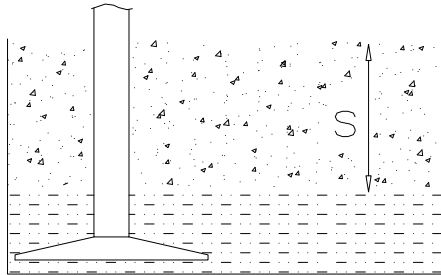
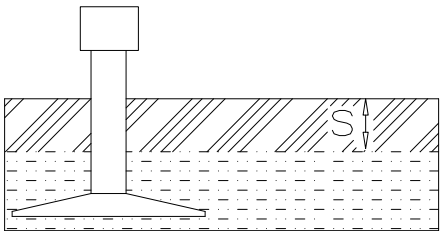
												
h < 1000	<p>Totally hard surfaces or materials with very limited impact attenuating properties.</p> <p>Case by case risk assessment is needed including e.g. evalution whether there is forced movement, what is the intended exexcise and where will the product be installed.</p>	<p>Totally hard surfaces. E.g. concrete or asphalt</p>  <p>Materials with very limited impact attenuating properties. E.g. wood</p> 										
h < 1200	<p>Materials with significant impact attenuating properties.</p>	<p>fine gravel 0–8 mm</p>  <p>Unsorted sand/ topsoil</p> 										
h < 1500		<p>Lawn</p> 										
h < 3000	<p>Loose fill material</p> <p>E.g. sand/gravel 0,25...8 mm D60/D10<3,0 Woodchips 5...30 mm bark 20...80 mm</p>	 <div><div><u>S</u> 30 cm 40 cm</div><div><u>h</u> < 2,0 m < 3,0 m</div></div>										
	<p>Syntethic granulates</p> <table><tr><td><u>S</u></td><td><u>h</u></td></tr><tr><td>40 mm ~></td><td>1,2...1,3 m</td></tr><tr><td>50 mm ~></td><td>1,5...1,7 m</td></tr><tr><td>60 mm ~></td><td>1,8...2,0 m</td></tr><tr><td>70 mm ~></td><td>2,1...2,5 m</td></tr></table> <p>Note. For accurate values, see manufacturer's instructions.</p>	<u>S</u>	<u>h</u>	40 mm ~>	1,2...1,3 m	50 mm ~>	1,5...1,7 m	60 mm ~>	1,8...2,0 m	70 mm ~>	2,1...2,5 m	
<u>S</u>	<u>h</u>											
40 mm ~>	1,2...1,3 m											
50 mm ~>	1,5...1,7 m											
60 mm ~>	1,8...2,0 m											
70 mm ~>	2,1...2,5 m											

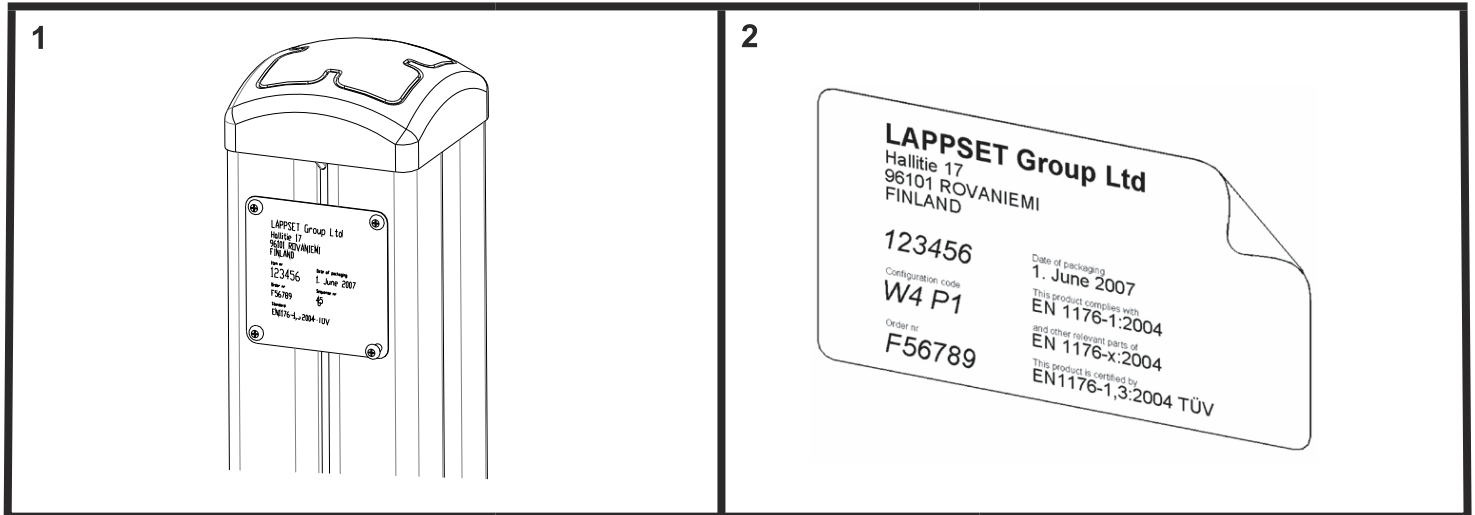

Tuotekyltti tulee tuotteen mukana yhdellä seuraavista tavoista:

1) Metallinen tuotekyltti ja kiinnitysruuvit

- Kiinnitä tuotekyltti ruuveilla tolppaan noin 2 metrin korkeuteen kuvan 1 mukaisesti.

2) Tuotekyltitarra

- Puhdista maalattu metalli- tai vaneripinta pölystä ja kosteudesta. Liimaa tarra kuvan 2 mukaisesti.
- Huom. Älä kiinnitä tarraa karheapintaiseen laminaattiin tai maalattuun puuhun.

Vår produktmärkning levereras på ett av följande sätt:

1) Produktskylt i metall

- Fäst skylten med de medföljande skruvarna

2) Självhäftande produktetikett

- Rengör den pulverlackerade metallytan eller laminatyten så att den blir fri från smuts och fukt. Fäst etiketten enligt fig. 2.
- Obs! Fäst ej etiketten på detaljer med skrovlig yta eller på målat trä.

Product label is delivered by one of following ways:

1) Metal product label and screws

- Fasten the label with screws.

2) Label sticker

- Clean the painted metal or plywood surface from dirt and moisture. Fasten the sticker as shown in the figure 2.
- Note. Do not attach the sticker to rough surfaced laminate or painted wood.

La plaque d'informations produit est livrée sous l'une de ces 3 formes :

1) Plaque métallique et vis

- Fixez la plaque à l'aide des vis.

2) Etiquette autocollante

- Avant de coller l'étiquette, nettoyez le composant métallique peint ou la plaque de contreplaqué, de toute saleté. La surface doit être sèche (voir image 2).
- Attention, ne pas coller l'étiquette sur une surface lamellé-collée irrégulière ou sur du bois peint.

Die Auslieferung des Produktaufklebers erfolgt auf eine dieser Arten:

1) Produkt-Schild aus Metall incl. Schrauben

- Die Befestigung des Schildes erfolgt mittels der Schrauben.

2) Aufkleber

- Entfernen Sie zunächst Schmutz und Feuchtigkeit vom lackierten Metall bzw. von der Holzoberfläche und bringen Sie den Aufkleber wie im Bild oben rechts beschrieben auf den gesäuberten Untergrund auf.
- Beachten Sie: Bringen Sie den Aufkleber nicht auf raues laminiertes oder lackiertes Holz an.